

JNQ16X16016 Courtyard Fountain Mixers (4) 16" Squares

FEATHERED STAR INSTRUCTIONS

Ziploc Storage Bags: You will need (3) bags to complete the organization for these instructions. Label the bags as follows to stay organized while cutting the Foundation Units and Templates.

- Bag #BF1: (4) each, Units BF1R-BF3R Foundation Papers and all associated (TLS)
- Bag #BF2: (4) each, Units BF1L-BF3L Foundation Papers and all associated (TLS)
- Bag #BF3: (1) each, Unit S1 through S4 Foundation Sheets, and associated Strip Template.

► Preparing the Foundation Papers:

Foundation Papers: This booklet includes enough foundation papers to complete (4) 16" squares assembled complete (1) 30" Feathered Star Block. The foundation papers and templates for this pattern are printed on newsprint. Newsprint is lightweight and tears away from your stitches without damaging the threads. Please pull apart this package and check, at this time, to make sure your pattern includes all of the newsprint listed below.

Cut out (4) each Unit BF1 through BF3 left & right units, and (1) each of Foundation Sheets S1 through S4, along with (1) of each Template and (TLS). See the newsprint graphics that follow for information on how to organize your units and templates into bags. *Refer back to General Information for Foundation papers and templates for additional instructions on how to prepare your foundation papers and templates.

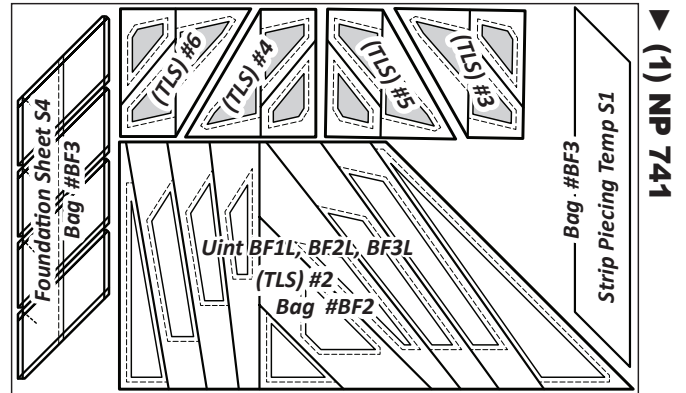

► Fabric Information:

The table below includes yardage, fabric numbers, and a reference to which fabrics go with the Templates and (TLS) to complete Units BF1-BF3. This table is your guide for not only selecting your own colors, but keeping you organized. Don't forget to cut a swatch of your chosen fabric to paste in the box in the Assigned Color column! This will help you stay organized!

Units BF1 - BF3 Yardage, Make (4) Left & Right Units		
GROUP-BF FABRIC #	YARDAGE INCH	ASSIGNED COLOR
Fabric BF1 Unit BF1/BF2 (TLS) #1 & #2	1-1/2 yds or (54")	Fabric Swatch
<p><i>If your pieces are all the same fabric for B2 & B3, and B4 & B5, you will not have issues with this correction.</i></p> <p><i>If your pieces are batik, and you already cut them, even if they are different, you can just flip them over and they will fit and you will not notice. For B4 and B5, you can just switch your Sew Side.</i></p> <p><i>If your quilt has different fabrics used for BF2, BF3, BF4, and BF5, and they are cottons, you are going to want to make sure you follow this correction below!</i></p>		

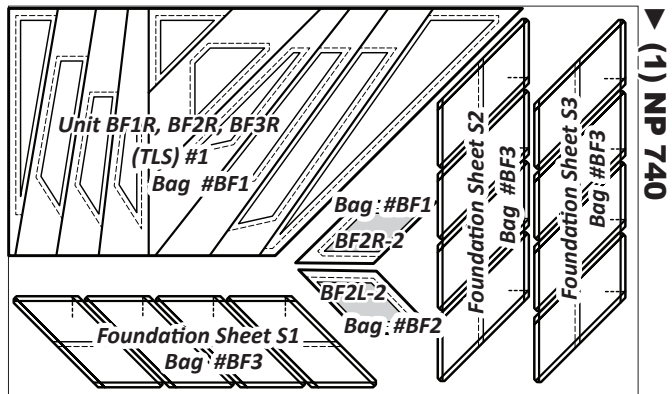
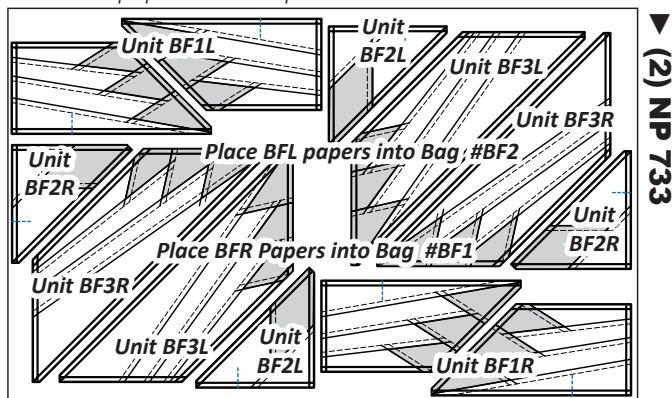

► Color Layout

The Color Layout for Group BF has been provided to help you match the fabric numbers up with the assigned Units on the yardage charts.

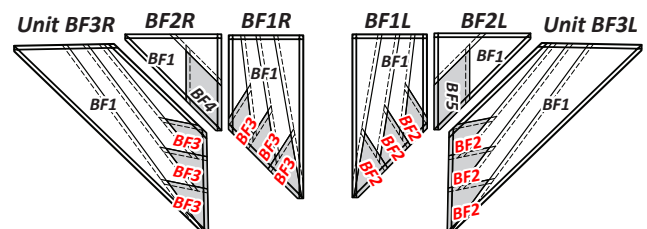

In Quiltster, BF2 and 3 are correct, but BF4 and BF5 were switched. So, on your kits, switch your BF4 and BF5 Labels!

NOTE - Why Backside?: The backside quilt image shown in the Color Layout matches your Fabric #s to the foundation paper and templates. Match the color layout to the papers can help keep you organized when adding the fabric pieces to the foundation.

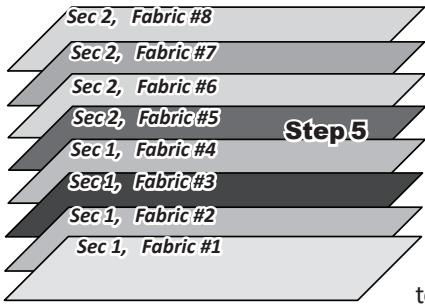

Step 5: The fabric strips labeled S1 through S4 are divided into two groups called Round One and Round Two.

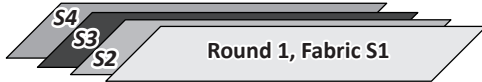
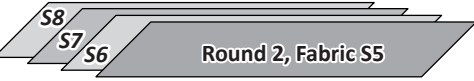

Step 6: Round 1 and Round 2 are stacked together placing Round 1 on

the top. The strip piecing process is designed to add each strip to the foundation papers in the sequence in which the fabric are stacked. The process is very simple if you follow the sewing step provided for each round on the following pages.

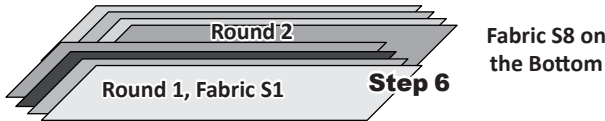

Fabric Layout:

Arrange the (8) fabric swatches cut from each of the eight colors onto the diamond layout in the order you want them to be sewn. When you are happy with the layout, the Fabric #s printed in each diamond are assigned to swatches associated to those diamonds. This fabric layout was created from the front-side of the finished block.

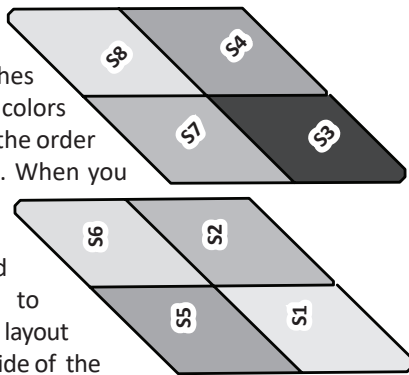

Preparing your Foundation Papers:

Position the (4) Foundation Sheets printed-side up on your table as shown below. Fabric swatches are pasted onto each foundation sheet as shown below.

Shifted Graphic up to Fix Formatting

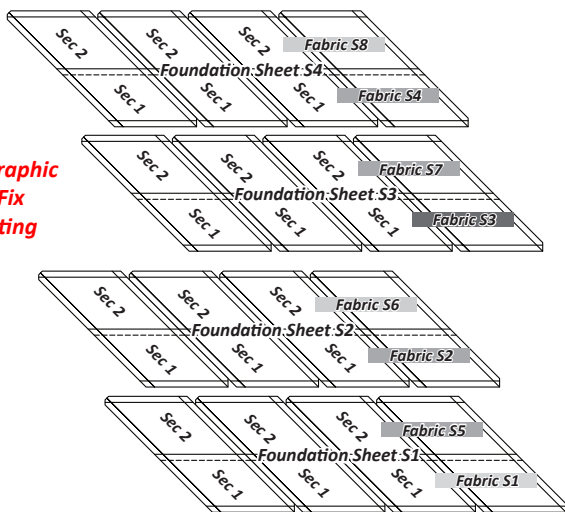

Stacking Order

The foundation sheets are stacked starting with **Foundation Sheet S4** on the bottom ending with **Foundation Sheet S1** on the top.

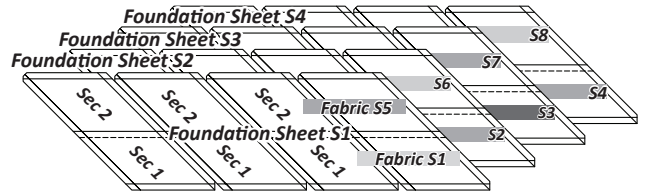

FOUNDATION PAPER PIECING BAG #BF3: FOUNDATION SHEETS S1 - S4

Round 1: Strips 1-4

The strips in the first round are glued onto the backside of each **Foundation Sheets S1-S4**.

1. Position Fabric S1, Strip #1, under Sec. 1 on Foundation Sheet S1.
2. Position Fabric S2, Strip #2, under Sec. 1 on Foundation Sheet S2.
3. Position Fabric S3, Strip #3, under Sec. 1 on Foundation Sheet S3.
4. Position Fabric S4, Strip #4, under Sec. 1 on Foundation Sheet S4.

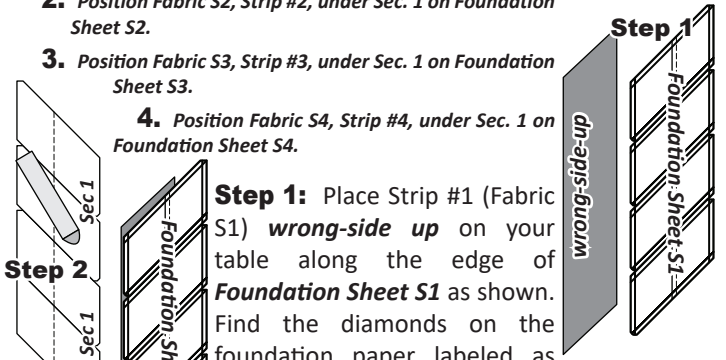

Step 1: Place Strip #1 (Fabric S1) **wrong-side up** on your table along the edge of **Foundation Sheet S1** as shown. Find the diamonds on the foundation paper labeled as Sec. 1.

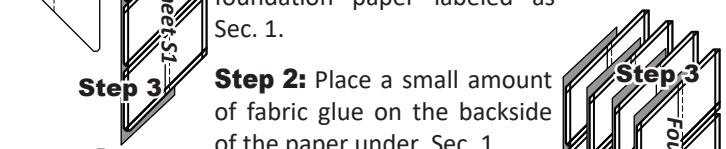

Step 2: Place a small amount of fabric glue on the backside of the paper under Sec. 1.

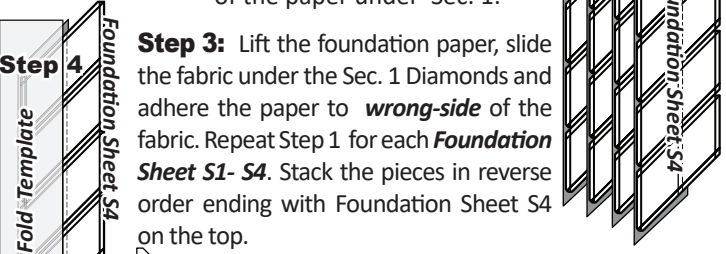

Step 3: Lift the foundation paper, slide the fabric under the Sec. 1 Diamonds and adhere the paper to **wrong-side** of the fabric. Repeat Step 1 for each **Foundation Sheet S1- S4**. Stack the pieces in reverse order ending with Foundation Sheet S4 on the top.

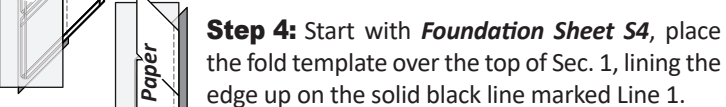

Step 4: Start with **Foundation Sheet S4**, place the fold template over the top of Sec. 1, lining the edge up on the solid black line marked Line 1.

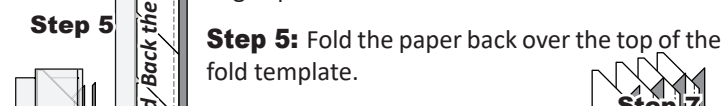

Step 5: Fold the paper back over the top of the fold template.

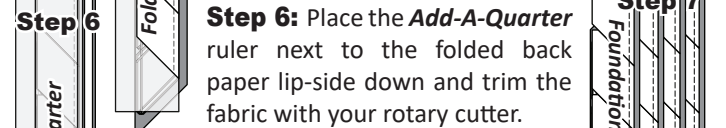

Step 6: Place the **Add-A-Quarter** ruler next to the folded back paper lip-side down and trim the fabric with your rotary cutter.

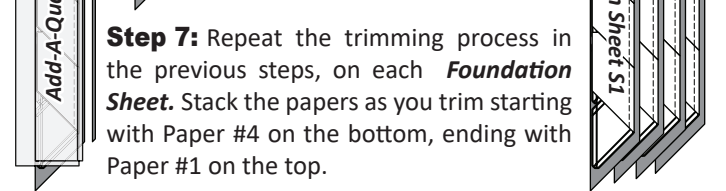

Step 7: Repeat the trimming process in the previous steps, on each **Foundation Sheet**. Stack the papers as you trim starting with Paper #4 on the bottom, ending with Paper #1 on the top.