

## GROUP K: WIND SPINNER TOP INSTRUCTIONS

**Ziploc Storage Bags:** You will need (2) bags to complete the organization for these instructions. Label the bags as follows to stay organized while cutting the Foundation Units and Templates.

- Bag #K1: (8) Unit KR Papers and Unit KR cutting templates
- Bag #K2: (8) Unit KL Papers and Unit KL cutting templates

### ► Preparing Foundation Papers & Templates:

**Step 1:** Cut out (8) ea. Unit KR & Unit KL, [NP 759 & NP 760]. The Unit KR and Unit KL Template Layout Sheets (TLS) are placed in a temporary bag. After the fabric has been cut the individual Sec. Templates for the (TLS) are placed into assigned Bag #s with their associated foundation papers. See the newsprint graphics that follow for information on how to organize your units and templates into bags. \*Refer back to General Information for Foundation papers and templates for additional instructions on how to prepare your foundation papers and templates.

**NOTE - Reusing Templates:** Templates and (TLS) are repositioned on the cut strips to achieve the number of cuts required in the cutting Instructions. Please read carefully to ensure the correct # of pieces are stacked beneath each Template before cutting.

#### ► (1) NP 759

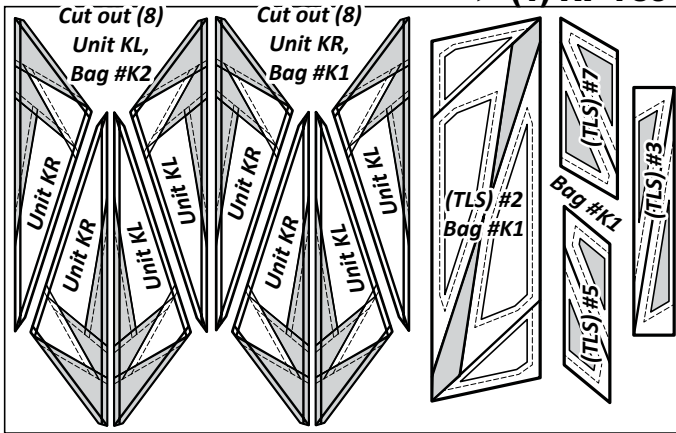

#### ► (1) NP 760

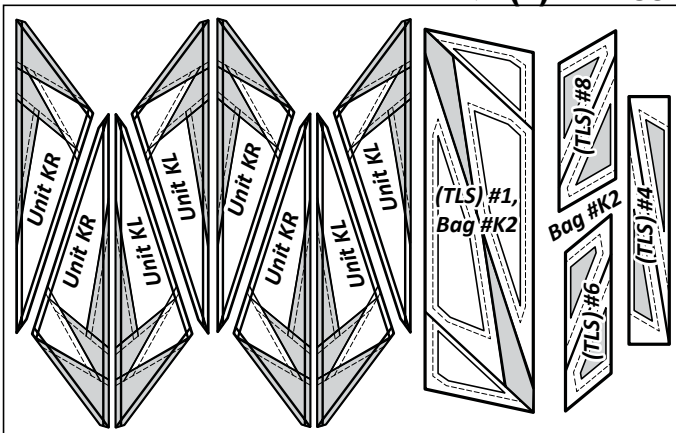

### ► Wind Spinner Top Fabric Information:

The Unit Chart that follows includes yardage, fabric numbers, and a reference to which fabrics go with the Templates and (TLS) to complete Units KL & KR. A color layout, shown below, gives a visual reference to where the fabrics are located on each unit.

#### Units KL & KR, Yardage, Make (8) ea.

GROUP K-005 FABRIC #	YARDAGE INCH	ASSIGNED COLOR
Fabric K1 Unit KL & KR, (TLS) #1 & #2	5/8 yd or (22")	Fabric Swatch
Fabric K2:a Unit KL & KR, (TLS) #3 & #4	1/8 yd or (4")	Fabric Swatch
Fabric K2:b Unit KL & KR, (TLS) #3 & #4	1/8 yd or (4")	Fabric Swatch
Fabric K3:a Unit KL & KR, (TLS) #5 & #6	1/8 yd or (2-1/2")	Fabric Swatch
Fabric K3:b Unit KL & KR, (TLS) #5 & #6	1/8 yd or (2-1/2")	Fabric Swatch
Fabric K4:a Unit KL & KR, (TLS) #5 & #6	1/8 yd or (3")	Fabric Swatch
Fabric K4:b Unit KL & KR, (TLS) #5 & #6	1/8 yd or (3")	Fabric Swatch

### ► Color Layout

#### NOTE - Backside Graphic:

The color layout shown matches the printed side of the paper, and the backside of the quilt.

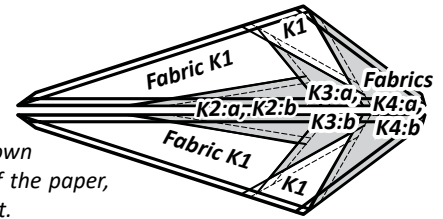

**NOTE - Stacking strips:** \*Templates and (TLS) are repositioned on the cut strips to achieve the number of cuts required in the cutting Instructions. Please read carefully to ensure the correct # of pieces are stacked beneath each Template before cutting.

**NOTE - Glue:** Repositionable glue placed on the backside of each template will keep the templates and (TLS) from moving in the cutting process. After each cut simply reposition the template to the next location.

### ► Fabric K1: (TLS) #1 & #2

**Step 1:** Cut and stack (4) 5-1/2" by 42" strips from Fabric K1 facing **right-side up** on your cutting table. **Unit KL, (TLS) #1** is placed onto the right half of the strips. **Unit KR, (TLS) #2** is placed onto the strips aligned with the left edge of the strips.

**Step 2:** Cut (4) pieces, matching the size and shape of each Layout Sheet. Reposition the templates as needed to get the required cuts.



**Step 3:** Eight (8) fabric pieces are stacked beneath each (TLS). The cutting is completed by slicing through the paper on each cut

**NOTE - Stacking strips:** \*Templates and (TLS) are repositioned on the cut strips to achieve the number of cuts required in the cutting Instructions. Please read carefully to ensure the correct # of pieces are stacked beneath each Template before cutting.

**NOTE - Glue:** Repositionable glue placed on the backside of each template will keep the templates and (TLS) from moving in the cutting process. After each cut simply reposition the template to the next location.

► **Fabric L1: (TLS) #1, #2**

**NOTE - Quiltster:** If you precut your fabric strips using the Quiltster APP, you will need to sub-cut each 8" strip into (2) 4" strips to achieve the number of strips listed in Step 1.

**Step 1:** Cut (8) 4" by 42" strips from *Fabric L1*. Divide the strips into (2) stacks of (4) strips each and position the strips facing *right-side up* on your cutting table.

**Step 2:** *Unit L1R & L2L (TLS) #1 and Temp L1L-2* are placed onto the first strip group. *Units L1L, & L2R (TLS) #2 and Temp L1R-2* are placed onto the second strip group.

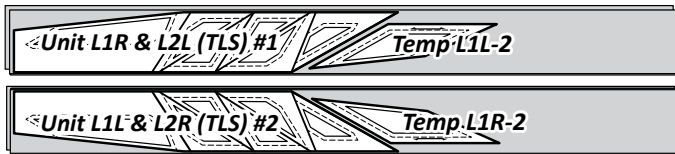

**Step 3:** Cut (4) pieces, matching the size and shape of each Layout Sheet.

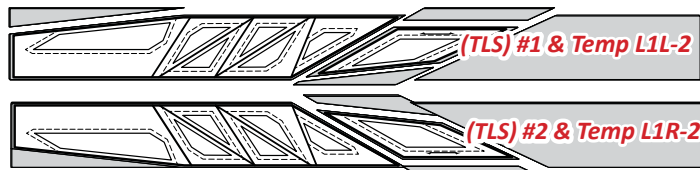

**Step 4:** You should have (4) fabric pieces stacked beneath each (TLS). The cutting is completed by slicing through the paper on each cut line in numerical order.

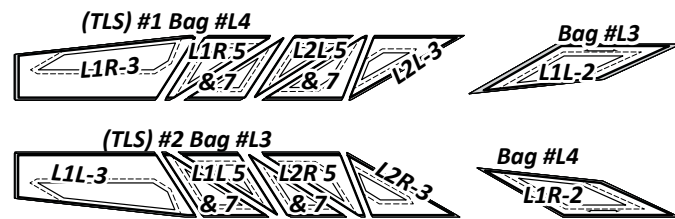

**Step 5:** Clip the template pieces to the fabric beneath and place into their assigned Bag #s.

► **Fabric L2: (TLS) #3, #4**

**Step 1:** Cut and stack (4) 4" by 42" strips from *Fabric L2*. Position the strips facing *right-side up* on your cutting table.

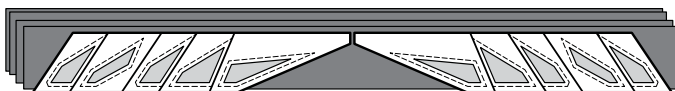

**Step 2:** *Unit L1R & L2L (TLS) #4* and *Unit L1L & L2R (TLS) #3* are placed onto the strips. Cut (4) pieces, matching the size and shape of each Layout Sheet.



**Step 3:** The cutting is completed by slicing through the paper on each cut line in numerical order to separate the individual sections.

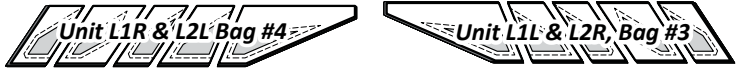

**Step 4:** Once the cutting is done, clip the template pieces to the fabric beneath and place into their assigned Bag #s.

■ **STACKING: UNITS L1R & L2L, BAG #4**

Position the templates and fabric pieces in numerical order facing *right-side up*, for *EACH* Unit L1R & L2L on your table with the *sew-sides* aligned at the top. Sec. 1 does not have a sew side.

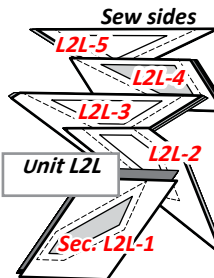
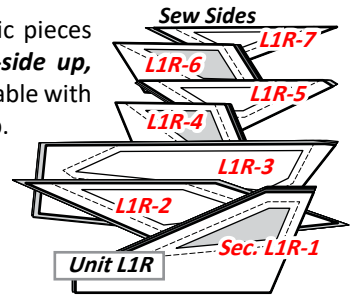

■ **Stacking:**

The stacking process begins with the largest Sec. # on the bottom. The pieces are stacked in reverse order finishing with Sec. 1 on top.

■ **FOUNDATION PAPER PIECING: UNIT L1R**

**NOTE - Tracing the Dashed Lines (optional):** Place the foundation paper onto a light table. Flip the foundation paper over and trace the dashed lines printed on the front side of the foundation paper onto the backside of the paper.

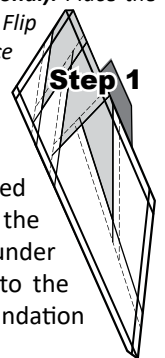
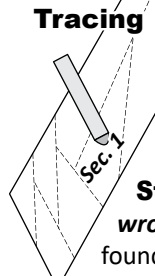

**Step 1:** The first piece of fabric is placed *wrong-side up* on your table. Lift the foundation paper, and slide the fabric under Sec. 1. Glue is used to adhere the fabric to the backside of the paper. Repeat **Step 1** for each foundation unit.

**Step 2:** Place the fold template over the top of Sec. 1, lining the edge up with the solid black line marked *Line 1*.

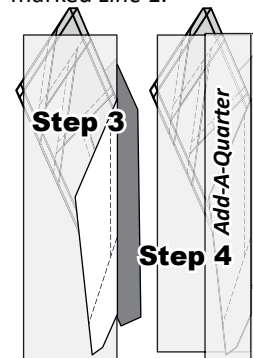

**Step 3:** Fold the paper back over the top of the fold template.

**Step 4:** Place the *Add-A-Quarter* ruler next to the folded paper and trim the fabric with your rotary cutter.

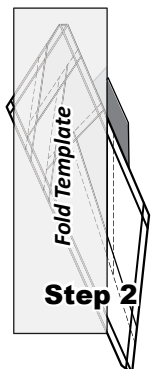

**Step 5:a** Place the fabric piece for *Sec. 2*, *right-side up* next to the folded back paper. **5:b** Lift the paper, and slide the fabric under *Sec. 1*, lining the sew side up with the trimmed seam allowance. Repeat **Steps 2–5** for each foundation paper before moving onto **Step 6**.

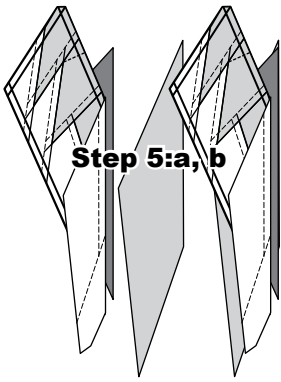

**Step 6:** Sew on *Line 1*. The stitches should start and stop about 1/8" past the beginning and the end of each stitch line. Complete the sewing on each unit before moving onto the next step.

**NOTE - Trimming the Threads:** Sewing past the ends of your sew line makes it possible to cut the thread ends off each time you trim with your **Add-A-Quarter** ruler.

**Step 7:** Loosen the glue under *Sec. 1*, then press the fabric pieces open on the backside of each paper.



**Step 8:** Position the fold template over the top of *Sections 1 and 2*, lining the edge up with *Line 2*.

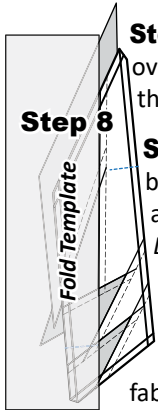

**Step 9:** Fold the paper back and tear the paper along the stitches on *Line 1*. Stop tearing when you hit the fold template.

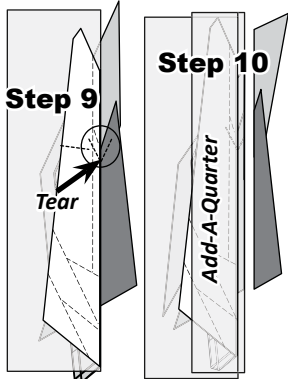

**Step 10:** Trim the fabric with the **Add-A-Quarter** ruler.

**Step 11:** Continue adding the remaining fabric pieces to each section on the foundation papers to complete the paper piecing.

**Transition & Registration Points (TRP Lines):** After the paper piecing is completed on each unit, the TRP lines are sewn along the edge onto the foundation papers. Trim the threads on the front and backside of the paper.

**Step 12:** The excess fabric is trimmed off on the solid line around the perimeter of the foundation paper. Place the pieces back into Bag #4, then repeat the previous steps to complete the paper piecing for Unit L2L.

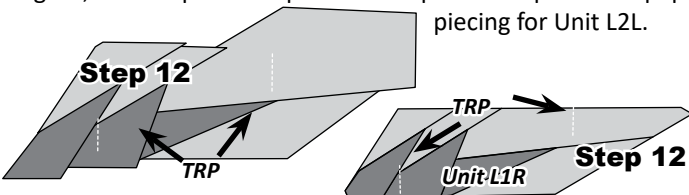

**NOTE - Removing the Foundation Paper:** Do not remove the foundation papers at this time.

## FOUNDATION PAPER PIECING: UNIT L2L

**NOTE - Tracing the Dashed Lines:** Place the foundation paper onto a light table. Flip the paper over and trace the dashed lines printed on the front side of the foundation paper onto the backside of the paper.

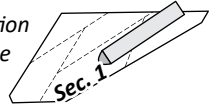

**Step 1:** The first piece of fabric is placed *wrong-side up* on your table. Lift the foundation paper, slide the fabric under *Sec. 1*. Glue is used to adhere the fabric to the backside of the paper. Repeat **Step 1** for each foundation unit.



**Step 2:** Place the fold template over the top of *Sec. 1*, lining the edge up with the solid black line marked *Line 1*.

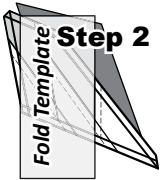

**Step 3:** Fold the paper back over the top of the fold template.

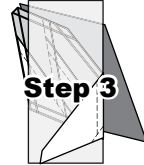

**Step 4:** Place the **Add-A-Quarter** ruler next to the folded paper and trim the fabric with your rotary cutter.

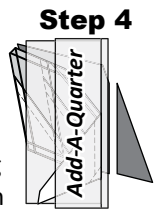

Continue adding the remaining fabric pieces to each section on the foundation papers to complete the paper piecing.

## STACKING: UNIT L1L & L2R, BAG # 3

**Stacking:** Position the templates and fabric pieces facing *right-side up*, for **EACH** Unit L1L & L2R with the **sew-sides** aligned at the top. *Sec. 1* does not have a sew side. The pieces are then stacked in reverse order starting with the largest # on the bottom finishing with *Sec. 1* on top.

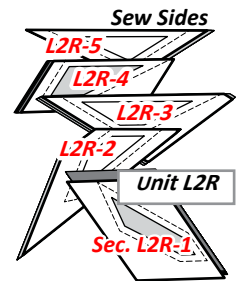
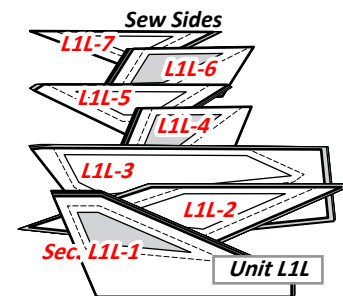

## FOUNDATION PIECING: UNIT L1L & L2R

**Step 1:** The beginning steps for paper piecing are the same for all units. We have shared with you the first two steps to get you started with the Units L1L & L2R. After the piecing is completed, sew the (TRP) lines and trim the excess fabric away around the perimeter of the foundation paper.

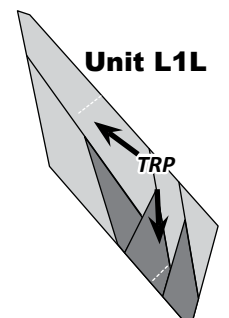
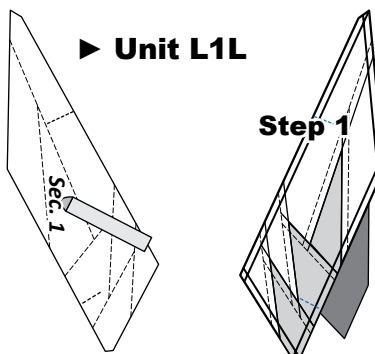

► **Unit L2R**

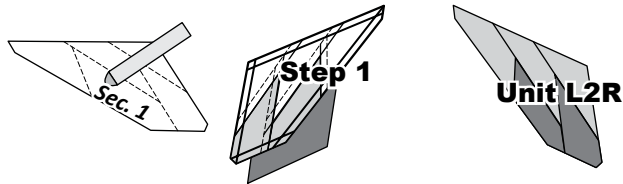

**Step 3:** [Strip Piecing Template SR] & [Strip Piecing Template SL] are placed onto the strips as shown.

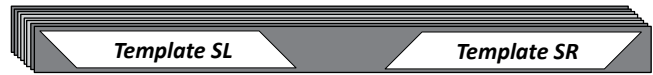

**Step 4:** One stack of (8) pieces, matching the size and shape of the template, are cut for each right & left template. Once the pieces are cut, clip the templates to the fabric beneath and place into their assigned Bags. Clip the remaining pieces together and set aside for fabric swatches.



**NOTE - Stacking Order is Critical!** Do not change the stacking order of the pieces you just cut. The cutting order is also the sewing order so no further sorting is needed. your pieces.

**FABRICS S1-S4: UNIT S1L, S2L, S1R, S2R**

The *Unit Chart* that follows includes yardage, fabric numbers, and a reference as to which fabrics go with the Templates and (TLS). It is a good idea to cut and paste a small fabric swatch for each of the boxes under Assigned Color. A front-side color layout has been provided for each left and right Unit. When setting up your colors on the foundation papers follow the instructions under Preparing the Foundation Sheets.

<b>Units S1L, S1R, S2L, S2R Yardage, Make (4) ea.</b>		
<b>GROUP-L-004 FABRIC #</b>	<b>YARDAGE INCH</b>	<b>ASSIGNED COLOR</b>
Fabric S1 Unit S1L, S1R	1/8 yd or (4-1/2")	Fabric Swatch
Fabric S2 Unit S2L, S2R	1/8 yd or (4-1/2")	Fabric Swatch
Fabric S3 Unit S1L, S1R	1/8 yd or (4-1/2")	Fabric Swatch
Fabric S4 Unit S2L, S2R	1/8 yd or (4-1/2")	Fabric Swatch

**PREPARING THE FOUNDATION SHEETS**

**Units SR1, SR2, SL1, & SL2:** The foundation papers for the diamonds were designed for strip piecing. The eight foundation sheets, are pieced by sewing two strips onto each sheet. **After the fabric is sewn onto the papers, the units are cut apart and reassembled to create (8) right and (8) left diamond groups.**

**Number the Foundation Sheets: Illustration One:** Number the front and backside of each Foundation Sheet in the upper left or right hand corner.

- Foundation Sheets S1R & S1L are numbered 1 & 2
- Foundation Sheets S2L & S2R are numbered 3 & 4



► **Illustration One**

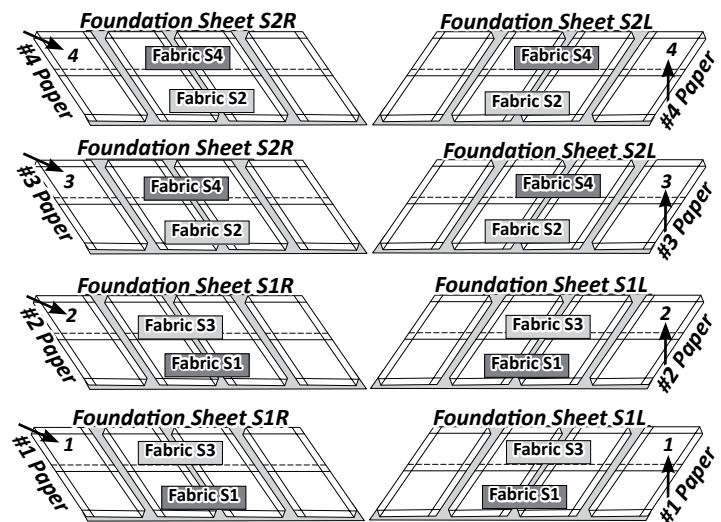

**CUTTING INSTRUCTIONS**

► **Fabric S1, S2, S3, S4**

**Step 1:** Cut and stack (2) 2-1/4" by 42" strips from each Fabric S1, S2, S3, & S4.

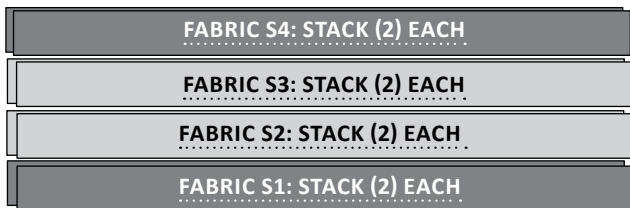

**Step 2:** Stack the strips facing *right-side up* on your cutting table starting with (2) ea. Fabric S4 on the bottom, ending with (2) ea. Fabric S1 on the top.

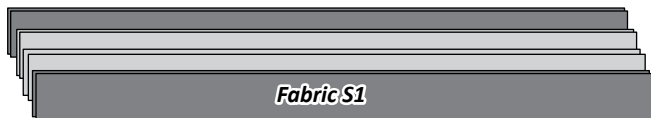

**Assigned Fabric #: Illustration One:** On each Foundation Sheet you will find two rows, each row includes four diamonds labeled as Sec. 1 & 2. Under each Sec. # you will find an assigned Fabric #. The Fabric #s are different on both Foundation Sheets S1 and S2.

- **Foundation Sheet S1R & S1L:** Fabric #1 is assigned to the diamonds in row 1 referenced for Sec. 1. Fabric #3 is assigned to the diamonds in Row 2 referenced for Sec. 2.

- **Foundation Sheet S2R & S2L:** Fabric #2 is assigned to the diamonds in row 1 referenced for Sec. 1. Fabric #4 is assigned to the diamonds in Row 2 referenced for Sec. 2.

**Fabric Swatches:** Illustration One (shown on previous page): I like to cut and paste a fabric swatch on each of the papers before I get started. This allows me to stack the papers to match the sewing order of my fabric strips. Cut (4) small fabric swatches from each color, from the left over end pieces set aside for the swatches. Fabric swatches for each Fabric # are then glued onto the foundation papers to prevent you from sewing the wrong colors under the wrong section numbers.

**Stacking the Papers:** Illustration Two: When you are done pasting the fabric swatches onto your papers, the papers for each right & left group are stacked in the sewing order starting with Paper #4 on the bottom, ending with Paper #1 on the top. Foundation Sheets S1R & S2R are placed into Bag #1. Foundation Sheets S1L & S2L are placed into Bag #2.

► **Illustration Two**

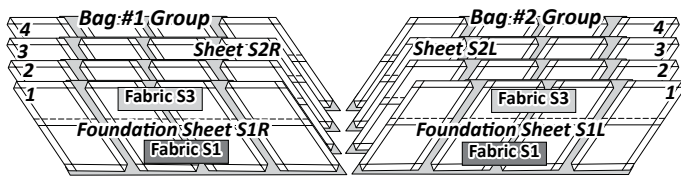

**FOUNDATION PIECING BAG #1 S1R & S2R**

► **Round 1: Strips 1-4**

The strips in the first round are glued onto the backside of each **Foundation Sheet S1R & S2R.**

1. Pair Fabric S1, Strip #1, to Paper #1, Sheet S1R, Sec 1.
2. Pair Fabric S1, Strip #2, to Paper #2, Sheet S1R, Sec 1.
3. Pair Fabric S2, Strip #3 to Paper #3, Sheet S2R, Sec 1.
4. Pair Fabric S2, Strip #4 to Paper #4, Sheet S2R, Sec 1.

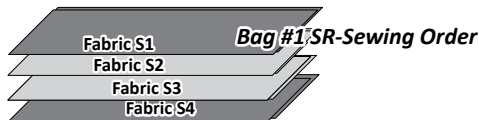

**Step 1:** Trace the dashed lines onto the backside of each Foundation Sheet. Find the diamonds labeled Sec.1 on Paper #1. Adhere a small amount of fabric glue on the backside of the paper under Sec. 1.

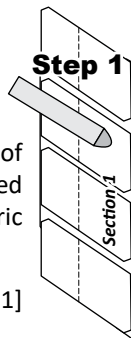

**Step 2:** Place Strip #1 [Fabric S1] **wrong-side up** along the edge of **Paper #1.** With the paper facing printed side up.

**Step 3:** Slide the fabric under the first row of diamonds and adhere the paper to the **wrong-side** of the fabric. Repeat for each **Paper #1-4,** restacking the paper units as you work through your stack. *Note; Fabric #2 strips are placed under the Sec. 1 rows on Foundation Sheet #2.*

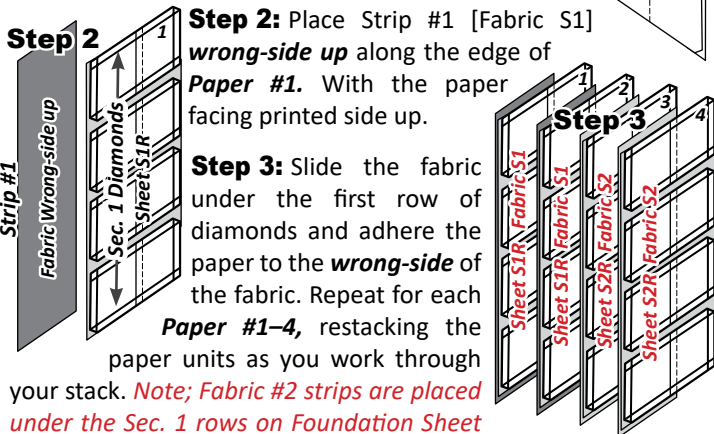

**Step 4:** Starting with the Foundation Sheet S2R, [#4] place the fold template over the top of Sec. 1, lining the edge up on the solid line labeled Line 1.

**Step 5:** Fold the paper back over the top of the fold template.

**Step 6:** Place the **Add-A-Quarter** ruler next to the folded back paper lip-side down and trim a 1/4" seam allowance.

**Step 7:** Repeat the trimming process in the previous Steps 5-6 on each of the Foundation Sheet. Stack the papers as you trim starting with Paper #4 on the bottom, ending with Paper #1 on the top as shown on the left.

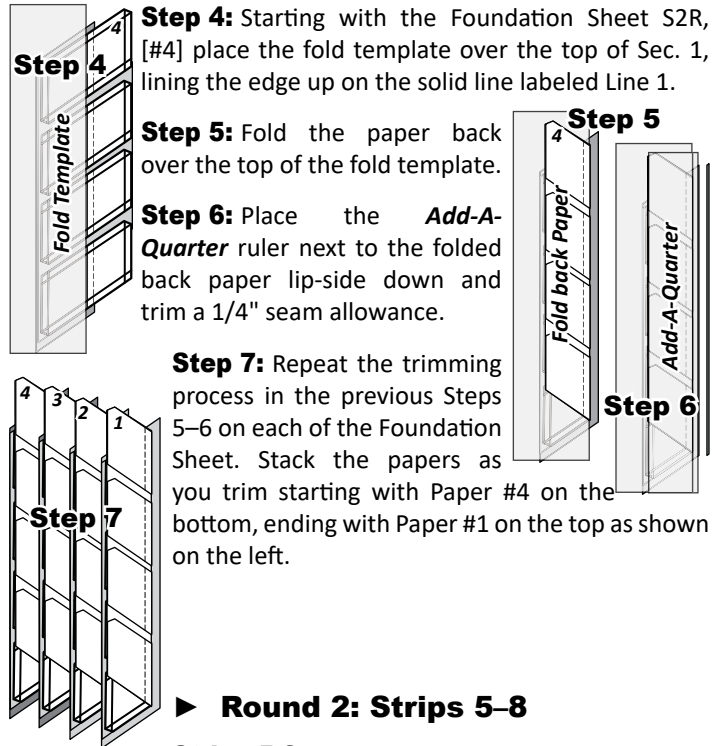

► **Round 2: Strips 5-8**

**Strips 5-8:** Are used to complete the sewing for Round 2 on each **Foundation Sheet S1R & S2R.**

1. Place Fabric S3, Strip 5 under Paper #1 Sheet S1R, Sec 2.
2. Place Fabric S3, Strip 6 under Paper #2 Sheet S1R, Sec 2.
3. Place Fabric S4, Strip 7 under Paper #3 Sheet S2R, Sec 2.
4. Place Fabric S4, Strip 8 under Paper #4 Sheet S2R, Sec 2.

**Step 1:** Position Strip #5, Round 2, [Fabric S3] **right-side up** on your table along the edge of **Foundation Sheet S1R** [1]. Lift the foundation paper, slide the strip under the **Section 2 Diamonds.** Line the raw edges along the trimmed sew-side.

**NOTE - Glue Helps!** A small amount of glue added between the fabrics along the raw edges of each fabric strip keep the edges together as you feed the fabric under the presser foot when sewing.

**Step 2:** Repeat **Step 1** for each **Paper #1 to #4, Bag #L1.** Make sure you use the correct strips.

**Step 3:** Fold open the paper and sew on Line 1. Complete the sewing on all four **Foundation Sheets.**

**Step 4:** When the sewing is complete, flip the papers over and press the fabric as shown on the backside of each paper.

