

**Step 4:** Fold the paper back over the top of the fold template.

**Step 5:** Place the *Add-A-Quarter* ruler next to the folded back paper lip-side down and trim the fabric with your rotary cutter.

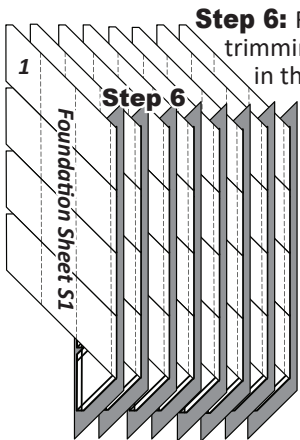

**Step 6:** Repeat the trimming process in the previous steps, on each *Foundation Sheet*. Stack the papers as you trim starting with Paper #8 on the bottom, ending with Paper #1 on the top.

► **Round 2:**

**Strips 1-8:** Round 2 strips 1-8 are positioned under the Sec. 2 diamonds on each *Foundation Sheet S1-4*.

1. Pair Fabric S5, Strip #1, to Foundation Sheet S1, Sec 2.
2. Pair Fabric S5, Strip #2 to Foundation Sheet S1, Sec 2.
3. Pair Fabric S6, Strip #3 to Foundation Sheet S2, Sec 2.
4. Pair Fabric S6, Strip #4 to Foundation Sheet S2, Sec 2.
5. Pair Fabric S7, Strip #5 to Foundation Sheet S3, Sec 2.
6. Pair Fabric S7, Strip #6 to Foundation Sheet S3, Sec 2.
7. Pair Fabric S8, Strip #7 to Foundation Sheet S4, Sec 2.
8. Pair Fabric S8, Strip #8 to Foundation Sheet S4, Sec 2.

**Step 1:** Position Strip #1, Round 2 (Fabric S5) *right-side-up* on your table along the edge of *Foundation Sheet S1*. Lift the foundation paper and slide the strip under the *Section 2 Diamonds*. Line the raw edges along the trimmed sew-side.

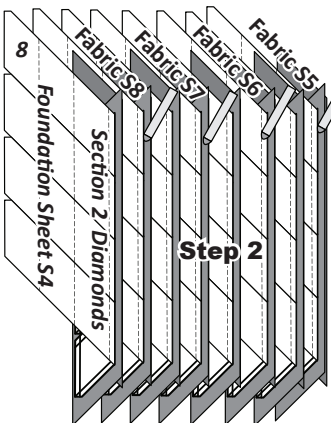

**Step 2:** Repeat Step 1 for each *Foundation Sheet*.

**NOTE - Glue Helps!:** A small amount of glue added along the raw edges of each fabric strip will keep the edges secure as you feed the fabric between the presser foot and feed dogs when sewing on Line 1.

**Step 3:** Open the papers and sew on Line 1. The stitches should start and stop about 1/8" before the beginning and end of Line 1.

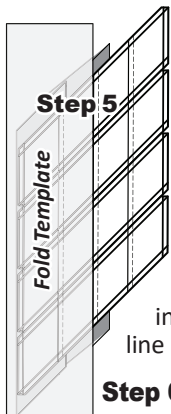

**Step 4:** Flip the papers over and press the fabric open on the backside of each *Foundation Sheet*.

**Step 5:** Start with *Foundation Sheet S4*, place the fold template over the top of Sec. 2, lining the edge up on the solid black line marked Line 2.

**Step 6:** Fold back the paper and trim a 1/4" seam allowance. Repeat the trimming process for each

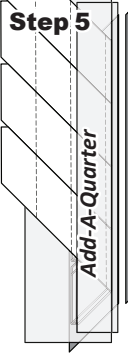
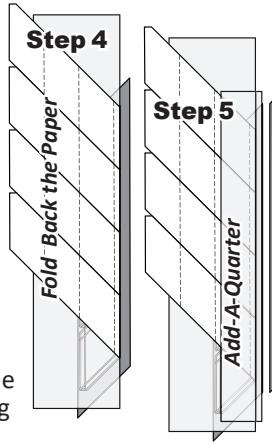
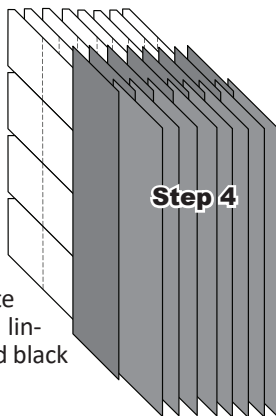

Foundation Sheet. Stack the papers as you trim. When you are done paper #8 should be on the bottom, paper #1 on the top.

► **Round 3: Strips 1-8:** Are used to complete the sewing for Round 3 on each *Foundation Sheet*.

1. Pair Fabric S9, Strip #1, to Foundation Sheet S1, Sec 3.
2. Pair Fabric S9, Strip #2 to Foundation Sheet S1, Sec 3.
3. Pair Fabric S10, Strip #3 to Foundation Sheet S2, Sec 3.
4. Pair Fabric S10, Strip #4 to Foundation Sheet S2, Sec 3.
5. Pair Fabric S11, Strip #5 to Foundation Sheet S3, Sec 3.
6. Pair Fabric S11, Strip #6 to Foundation Sheet S3, Sec 3.
7. Pair Fabric S12, Strip #7 to Foundation Sheet S4, Sec 3.
8. Pair Fabric S12, Strip #8 to Foundation Sheet S4, Sec 3.

► **Round 4: Strips 1-8:** Are used to complete the sewing for Round 4 on each *Foundation Sheet*.

1. Pair Fabric S13, Strip #1, to Foundation Sheet S1, Sec 4.
2. Pair Fabric S13, Strip #2 to Foundation Sheet S1, Sec 4.
3. Pair Fabric S14, Strip #3 to Foundation Sheet S2, Sec 4.
4. Pair Fabric S14, Strip #4 to Foundation Sheet S2, Sec 4.
5. Pair Fabric S15, Strip #5 to Foundation Sheet S3, Sec 4.
6. Pair Fabric S15, Strip #6 to Foundation Sheet S3, Sec 4.
7. Pair Fabric S16, Strip #7 to Foundation Sheet S4, Sec 4.
8. Pair Fabric S16, Strip #8 to Foundation Sheet S4, Sec 4.

**PART 2: TRIM AND CUT THE PAPERS**

**Step 1:** Before trimming and cutting the foundation sheets apart, you must add the TRP lines. To accomplish this, find the lines on Foundation Sheets S3, and S4 that are labeled as TRP (S4 image shown). Set your machine to sew a basting stitch (minimum stitch length of 2.8), then sew on each of the TRP lines. You do not need to remove the Foundation Sheet from the machine for each new TRP line, just slide the paper to the next line to add them, then trim away the excess thread before moving to the next step.

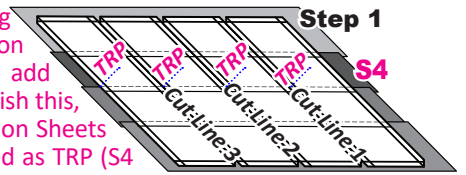

**Step 2:** Then the excess fabric and paper is trimmed off along the top and bottom edge of each foundation sheet. There are two solid lines printed around the perimeter of the paper. The last line that borders the edge of the foundation sheet is the trim line.

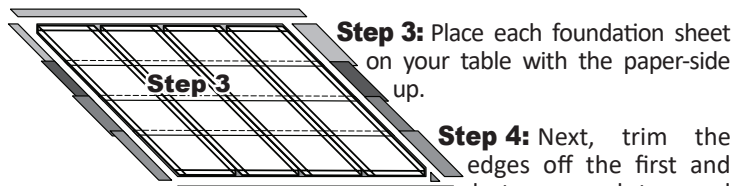

**Step 3:** Place each foundation sheet on your table with the paper-side up.

**Step 4:** Next, trim the edges off the first and last row and top and bottom. Find the three lines referred to as *Cut Line 1, 2, & 3*. These are your cutting lines. Using your ruler and rotary cutter, cut each line to separate the four rows.

**Step 5:** Next, trim off the tips and the shaded areas to complete the cutting for all the excess fabric and smart corners.

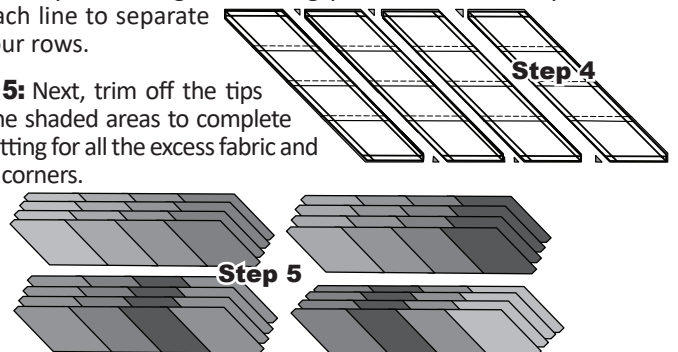

**Step 6:** Clip the pieces for each row together and set aside. Repeat Steps 1-5 to complete the remaining sheets.