

Step 2: Line the fold template up with Sec. 1. Fold the paper back, position the ADD-A-Quarter, and trim the fabric with your rotary cutter.

Step 2

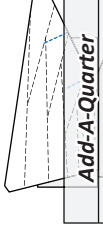

Step 3: Fabric #2 is positioned under Sec. 2 facing *right-side-up*.

Step 3

Step 4: Continue adding the fabrics for each section to the foundation papers. When you are done, sew the TRP Lines using a 2.8 stitch length basting stitch and complete the trimming for each unit.

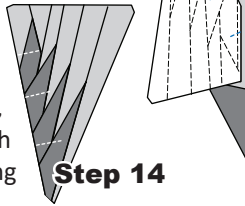

ASSEMBLE THE SNOWFLAKE BLOCK AA

Step 1: Remove the foundation paper from the backside of each Unit AA1 and AA2 at this time. Match and pin the (TRP) lines. A small amount of glue is used to match both ends secure before sewing. After the pieces are sewn the seams are pressed towards Unit AA1. This will leave you with opposing seams when you join the blocks. If you need to reduce bulk you may want to press the seams in towards the star in which case you will end up with stacked seams when you join the blocks.

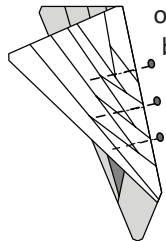

Step 2: Arrange the pieces as shown below, *right-side-up* on your table.

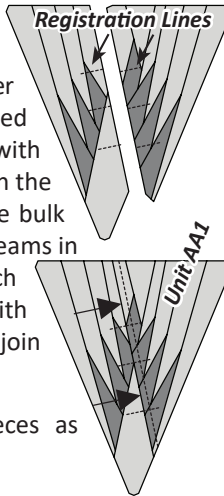

Step 3: T-Template AA1 is now sewn onto the four corner wedges. The seams are pressed towards Template AA1.

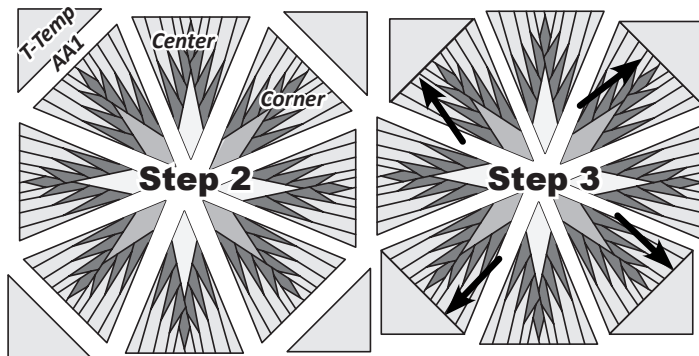

Step 4: The corner wedges are sewn onto the center wedges. The seams are pressed towards the center wedges.

Step 5: The corner groups are joined to complete two half pieces.

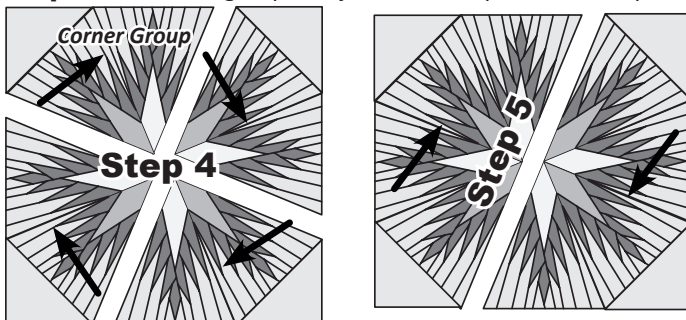

Step 6: The half pieces are joined to complete the blocks.

Pressing the last seam: When the blocks are completed, pick back the stitches at the intersection in the center of each star, twist the seams in opposing directions to complete the pressing on each block.

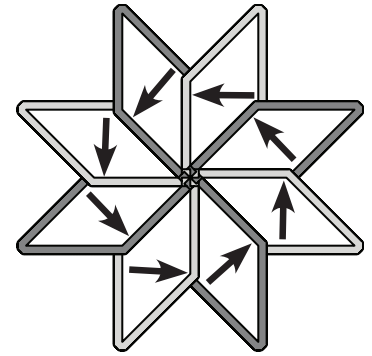
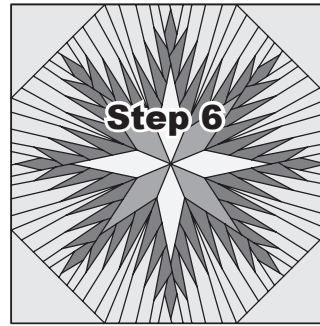

BACKSIDE VIEW

COMPASS BLOCK AB INSTRUCTIONS

► Foundation Papers and Templates:

Ziploc Storage Bags: You need (6) small bags, and (1) large bag to complete the organization for Units AB1 through AB6.

- Bag #AB1 [Small]: (8) Unit AB1 Foundation papers.
- Bag #AB2 [Small]: (8) Unit AB2 Foundation papers.
- Bag #AB3 [Small]: (8) Unit AB3 Foundation papers.
- Bag #AB4 [Small]: (8) Unit AB4 Foundation papers.
- Bag #AB5 [Small]: (8) Unit AB5 Foundation papers.
- Bag #AB6 [Small]: (8) Unit AB6 Foundation papers.
- Bag #AB7 [Large]: (4) each of the Templates and Templates Layout sheets associated with Units AB1 through AB6.

► Preparing the Foundation Papers:

Step 1: Cut out the Foundation Papers for Units AB1 through AB2 along with the associated Templates and Template Layout Sheets [NP 595]. See the newsprint graphic below as a reference to organize your units and templates into bags. *Refer back to General Information for Foundation Papers and Templates for additional instructions on how to prepare your foundation papers and templates.

► (4) NP 595

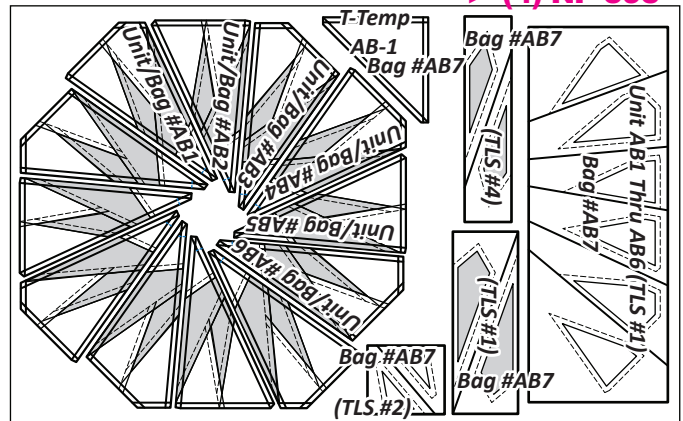

GROUP B INSTRUCTIONS

► T-Templates:

Ziploc Storage Bags: You need (1) bag to complete the organization for Group B.

- Bag #B1: (3) each T-Templates B1, (1) T-Template B2, (1) T-Template B3, (1) T-Template B4, (1) T-Template B5, (1) T-Template B6.

► Preparing the T-Templates:

The T-Templates on [TP 442] are cut out and placed in Bag #B1. See the newsprint graphic below as a reference to organize your units and templates into bags. *Refer back to General Information for Foundation Papers and Templates for additional instructions on how to prepare your foundation papers and templates.

► (1) TP 442

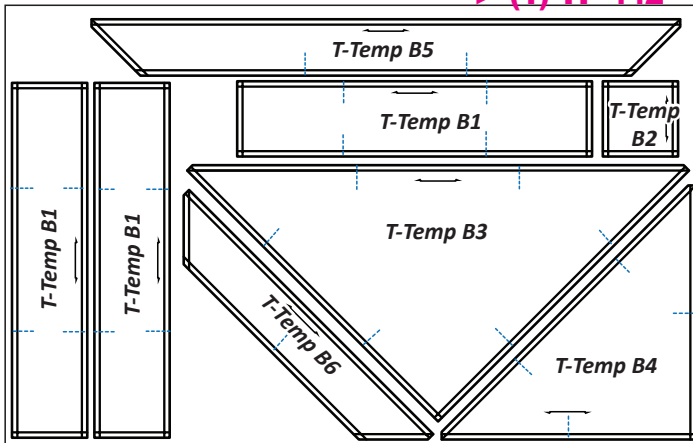

FEATHERED STAR FABRIC INFORMATION

Reference the Unit Chart below and color layout for yardage, fabric references, and swatch boxes to organize your fabrics.

T-Templates B1 thru B6:		
GROUP B FABRIC #	YARDAGE OR INCHES	ASSIGNED COLOR
Fabric B1 T-Template B3 & B4	1-1/2 yds or (50")	FABRIC SWATCH
Fabric B2 T-Template B2	3/8 yd or (10-1/2")	FABRIC SWATCH
Fabric B3 T-Template B1	1-1/2 yds or (49-1/2")	FABRIC SWATCH
Fabric B4 T-Template B5 & B6	3/4 yd or (24")	FABRIC SWATCH

► Color Block Layout

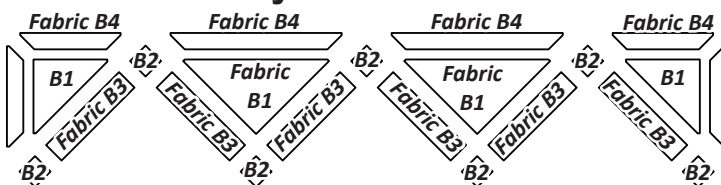

CUTTING INSTRUCTION BAG B1

► Fabric B1: (T-Temp B3 & B4)

Step 1: Cut (4) 12-1/2" x 42" strips from Fabric B1. Open and re-stack the strips facing *right-side-up* into one stack. *T-Temp B4* is used to cut (4) pieces and *T-Template B3* is used to cut (8) pieces. Place these pieces in Bag #B1.

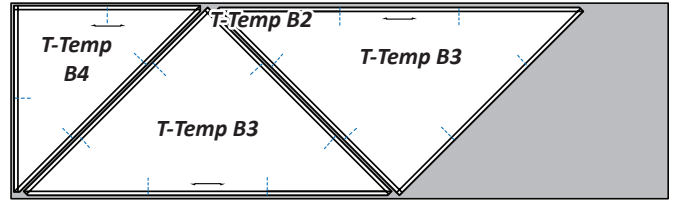

► Fabric B2: (T-Temp B2)

Step 2: Cut (3) 3-1/2" x 42" strips from Fabric B2. Open and re-stack the strips facing *right-side-up* into one stack. *T-Temp B2* is used to cut (24) pieces. Place these pieces in Bag #B1.



► Fabric B3: (T-Temp B1)

Step 3: Cut (3) 16-1/2" x 42" strips from Fabric B3. Open and re-stack the strips facing *right-side-up* into one stack. *T-Temp B1* is used to cut (36) pieces. Place these pieces in Bag #B1.

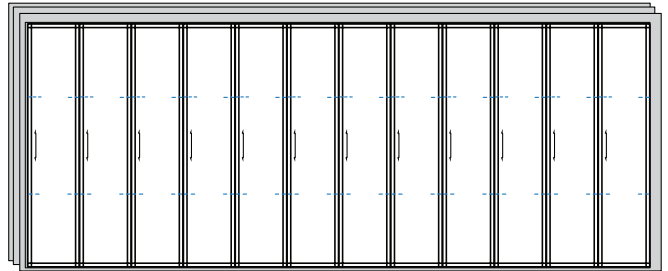

► Fabric B4: (T-Temp B5 & B6)

Step 4: Cut (8) 3" x 42" strips from Fabric B4. Open and re-stack the strips facing *right-side-up* into one stack. *T-Temp B5 and B6* are used to cut (8) pieces for each template. Place these pieces in Bag #B1.



► Marking the (TRP) Registration Lines:

We have added (TRP) registration lines to each of the T-Templates. The registration lines on T-Template B1 are matched up with the corner triangles sewn on your 16" square blocks. I would normally tell you to sew the registration line, but I believe it will be just as easy to mark these with a light pencil or even with a pin just prior to adding the pieces onto your blocks. So, it is up to you how you mark them.

Registration lines have also been added to the set-in triangles cut with T-Templates B3-B6. Having these points should help keep your pieces squared up when sewing along the bias edges of the triangles cut with T-Temp B-5 & B-6.

