

Step 8: After the trimming is completed with the *Add-A-Quarter* ruler, stack the units, leaving the papers in the folded back position.

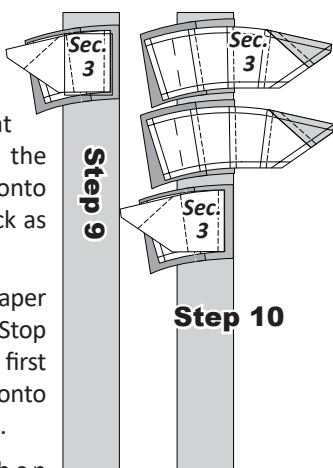

Step 8

Step 9: Place Strip #3, (Color 2), right-side-up at your machine next to the feed dogs. Position the first arc onto the strip with the paper folded back as shown.



Step 9

Step 10

Step 10: Open the foundation paper on each piece, and sew on Line 2. Stop before you get to the end of the first paper and position a second unit onto the fabric strip.

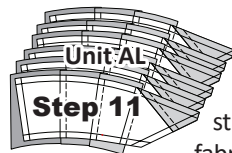

Step 11

Step 11: When the sewing is completed, carry the papers and strips back to your cutting board. Position the fabric on the board, paper-side-up and cut between the foundation papers with your rotary cutter to separate each unit. Stack the pieces paper-side-up.

Step 12: Line the fold template up with Line 3 on the paper. Fold back the paper and trim the fabric with your rotary cutter.

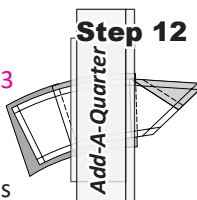

Step 12

Step 13: At this time the excess fabric is trimmed along the edges.

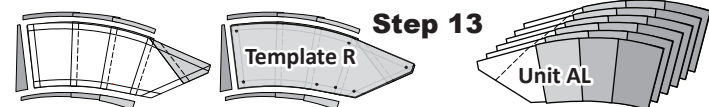

Step 13

Center Background Template: The (6) pieces cut with DWR Background T-Template D are now sewn onto the foundation papers.

Step 14: Locate the 1/4 inch intersecting points on both pieces. CGRDIA Templates were designed with drilled holes at each intersection.

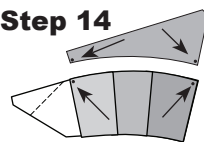

Step 15: Position the pieces cut from T-Template D onto the top of Unit-AL, with right-sides-together. With the Smart Corners built into the template pieces you will find it each to match and pin both ends. Glue the edges along the curve. The glue should only be added along the edge of the fabric, keeping the glue so it falls within the seam allowance area.

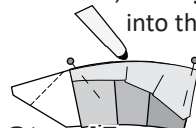

Step 15

Step 16: Position both pieces at your machine. Place Unit AL, paper-side-down, next to the feed dogs and sew the two (2) pieces together using a quarter-inch seam allowance.



Step 16

NOTE - Purple Thang: The Purple Thang works great as a third finger when sewing the curves. It can be used to smooth out any pleats you might run into and is very helpful in holding the fabric edges together as you complete your sewing.

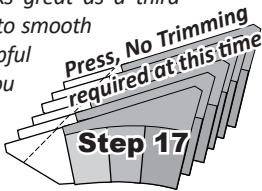

Step 17

Step 17: Press towards T-Temp. D.

► The Strip Piecing Continues with Strip #4

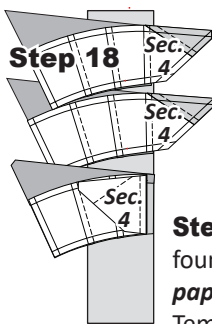

Step 18

Step 18: The papers are positioned onto Strip #4, (Color 1) as shown in the graphic to the left. When the strip piecing is done, press the fabric open on the backside of the paper and cut the units apart.

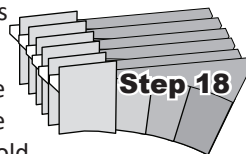

Step 18

Step 19: Reposition the foundation units with the paper-side-up. Place the Fold Template on Line 3. Fold back the paper. Place the *Add-A-Quarter* ruler next to the folded back paper, and trim a quarter-inch seam.

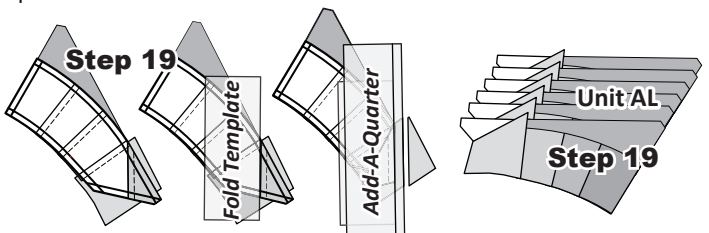

Step 19

Step 19

► Wings, Template A-2, Fabric S9

Step 20: Place the fabric piece for Sec. 5, right-side-up next to the folded back paper as shown.

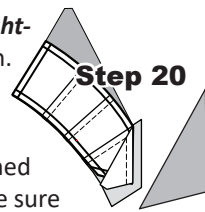

Step 20

Step 21: Lift the foundation paper and slide the fabric under Sec. 2. Line the sew-side up with the trimmed quarter-inch seam allowance. Make sure the fabric extends beyond the boundaries of the wing section.



Step 21

Step 22: Open the paper and sew on Line 4. The stitches should start and stop at the edge of the paper.

Step 23: Press the fabric pieces open on the backside of the paper. Then sew each TRP Line with a basting stitch length 2.8.



Step 23

Step 24: Flip the papers over so the paper side is up and use a straight edge ruler lined up to the edge on T-Template D to trim the excess fabric off from around the edges on the wing and Sec. 4.

NOTE - Trimming Hints: Do not trim off the Center Background Pieces and don't forget to trim the Smart Corners!

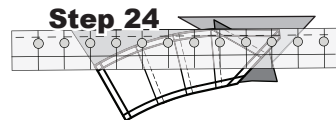

Step 24

NOTE - Foundation Paper: Do not remove the foundation paper at this time. The paper will be removed just prior to completing the curved piecing on the Melon pieces cut from DWR T-Template E.

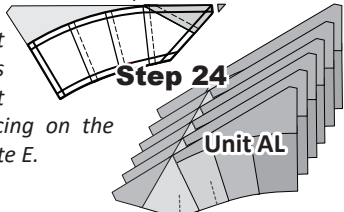

Step 24

► Unit BR:

The BR Units were designed with one additional piece, (Sec. 6) which is the last piece sewn onto the foundation papers. The pieces for Sec. 6 were cut using the **Unit BR Template B-1 Layout Sheet**. You should have (6) pieces cut from Fabric S11.

Step 1: The strip piecing begins again with Unit BR. Stack the strips starting with Fabric #1 [Color 4] and Fabric #2 [Color 3] facing right-sides together.