

**NOTE - Stacking Order is Critical!:** Do not change the stacking order of the pieces you just cut and organized. The cutting order is also the sewing order so no further sorting is needed.

## PREPARING THE FOUNDATION SHEETS

**Units SR1, SR2, SL1, & SL2:** The foundation papers for the diamonds were designed for strip piecing. The eight foundation sheets, are pieced by sewing two strips onto each sheet. After the fabric is sewn onto the papers the units are cut apart and reassembled to create (8) right and (8) left diamond groups.

**Alchemists Crystals Paper Modifications:** In Alchemists Crystals, we will need to cut our Foundation Sheets in Half before we complete the foundation paper piecing. The original papers were designed so (4) units would be identical, but the color layout used for Alchemist Crystals requires that only (2) units are identical. As such, the first step is to slice your Foundation Sheets in half so there are (8) R Units, and (8) L Units.

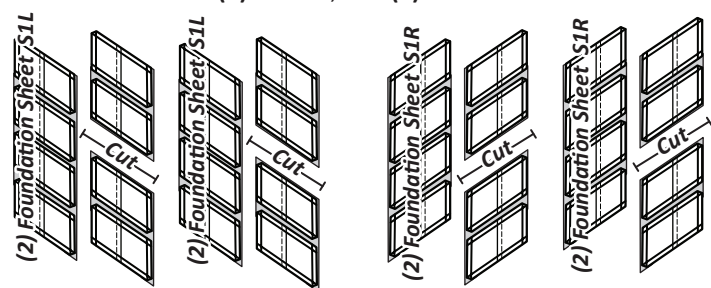

### Number the Foundation Sheets: Illustration One:

Number the front and backside of each Foundation Sheet in the upper left or right hand corner. Only the Bag #L1 (Right) foundation sheets are shown. But, the Bag #L2 (Left) Foundation Sheets are done the same way.

- Foundation Sheets S1R & S1L are numbered 1, 2, 3, & 4
- Foundation Sheets S2L & S2R are numbered 5, 6, 7, & 8

### Assigned Fabric #:

**Illustration One:** On each Foundation Sheet, you will find two rows, each row includes two diamonds labeled as Sec. 1 & 2. Under each Sec. # you will find an assigned Fabric #. The Fabric #s are different on both Foundation Sheets S1R and S2R.

- **Foundation Sheet S1R & S1L:** Fabric #S1 is assigned to the diamonds in Row 1 referenced for Sec. 1. **Fabrics RB1, RB3, RB5, and RB7** are assigned to the diamonds labeled as Fabric #3 in Row 2 referenced for Sec. 2.
- **Foundation Sheet S2R & S2L:** **Fabric #RB2, RB4, RB6, and RB8** is assigned to the diamonds in Row 1, labeled as Fabric #2 for Sec. 1. Fabric #S4 is assigned to the diamonds in Row 2 referenced for Sec. 2.

### ILLUSTRATION 1

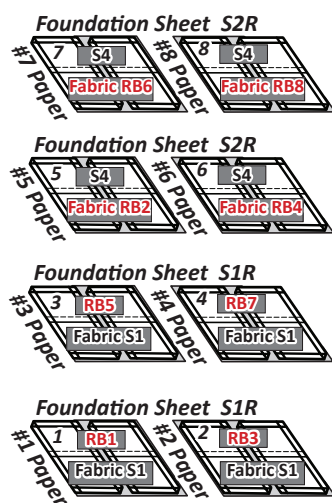

**Fabric Swatches: Illustration One:** I like to cut and paste a fabric swatch on each of the papers before I get started. This allows me to stack the papers to match the sewing order of my fabric strips. Cut small fabric swatches from each color, from the leftover end pieces set aside for the swatches. Fabric swatches for each Fabric # are then glued onto the foundation papers to prevent you from sewing the wrong colors under the wrong section numbers.

### Stacking the Papers: Illustration Two:

When you are done pasting the fabric swatches onto your papers, the papers for each right & left group are stacked in the sewing order starting with Paper #8 on the bottom, ending with Paper #1 on the top. Foundation Sheets S1R & S2R are placed into Bag #L1 (stacking graphic shown to right). Foundation Sheets S1L & S2L are placed into Bag #L2 (Stacking is the same, just with the S1L and S2L Foundation Sheets, no graphic shown).

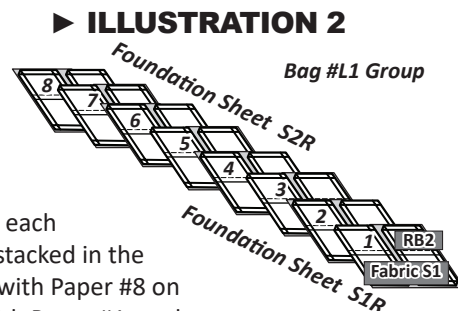

## FOUNDATION PIECING BAG #1 S1R & S2R

### Round 1: Fabrics S1, RB2, 4, 6, and 8

The strips in the first round are glued onto the backside of each Foundation Sheet S1R & S2R.

1. Pair Fabric S1, Strip #1, to Paper #1, Sheet S1R, Sec 1.
2. Pair Fabric S1, Strip #2, to Paper #2, Sheet S1R, Sec 1.
3. Pair Fabric S1, Strip #3, to Paper #3, Sheet S1R, Sec 1.
4. Pair Fabric S1, Strip #4, to Paper #4, Sheet S1R, Sec 1.
5. Pair Fabric RB2, Strip #5 to Paper #5, Sheet S2R, Sec 1.
6. Pair Fabric RB4, Strip #6, to Paper #6, Sheet S2R, Sec 1.
7. Pair Fabric RB6, Strip #7, to Paper #7, Sheet S2R, Sec 1.
8. Pair Fabric RB8, Strip #8, to Paper #8, Sheet S2R, Sec 1.

**Step 1:** Trace the dashed lines onto the backside of each Foundation Sheet. Find the diamonds labeled Sec. 1 on Paper #1. Adhere a small amount of fabric glue on the backside of the paper under Sec. 1.

### Step 1

### Step 2

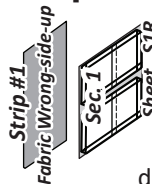

**Step 2:** Place Strip #1 [Fabric S1] **wrong-side-up** along the edge of **Paper #1**. With the paper facing printed side up.



**Step 3:** Slide the fabric under the first row of diamonds and adhere the paper to the **wrong-side** of the fabric. Repeat for each **Paper #1 through #8**, re-stacking the paper units as you work through your stack. *Note: Fabrics RB2, RB4, RB6, and RB8 strips are placed under the Sec. 1 rows on Foundation Sheet S2R.*

### Step 3



### Step 4

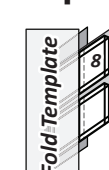

**Step 4:** Starting with the Foundation Sheet S2R, [#8] place the fold template over the top of Sec. 1, lining the edge up on the solid line labeled Line 1.

**Step 5:** Fold the paper back over the top of the fold template.

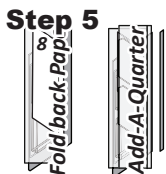

**Step 6:** Place the *Add-A-Quarter* ruler next to the folded back paper lip-side down and trim a 1/4" seam allowance.

**Step 7:** Repeat the trimming process in the previous Steps

5-6 on each of the Foundation Sheet. Stack the papers as you trim starting with Paper #8 on the bottom, ending with Paper #1 on the top as shown on the left.

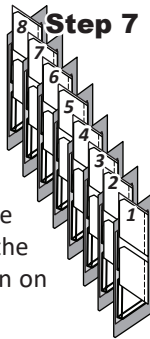

► **Round 2: Strips RB1, 3, 5, 7, and S4**

**Fabrics RB1, 3, 5, and 7, and S4:** Are used to complete the sewing for Round 2 on each Foundation Sheet S1R & SR2.

1. Place Fabric RB1, Strip 9 under Paper #1 Sheet S1R, Sec 2.
2. Place Fabric RB3, Strip 10 under Paper #2 Sheet S1R, Sec 2.
3. Place Fabric RB5, Strip 11 under Paper #3 Sheet S1R, Sec 2.
4. Place Fabric RB7, Strip 12 under Paper #4 Sheet S1R, Sec 2.
5. Place Fabric S4, Strip 13 under Paper #5 Sheet S2R, Sec 2.
6. Place Fabric S4, Strip 14 under Paper #6 Sheet S2R, Sec 2.
7. Place Fabric S4, Strip 15 under Paper #7 Sheet S2R, Sec 2.
8. Place Fabric S4, Strip 16 under Paper #8 Sheet S2R, Sec 2.

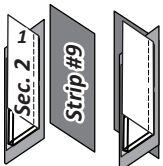

**Step 1**

**Step 1:** Position Strip #9, Round 2, [Fabric RB1] *right-side-up* on your table along the edge of *Foundation Sheet S1R* [Paper #1]. Lift the foundation paper, slide the strip under the *Section 2 Diamonds*. Line the raw edges along the trimmed sew-side.

**NOTE - Glue Helps!:** A small amount of glue added between the fabrics along the raw edges of each fabric strip keep the edges together as you feed the fabric under the presser foot when sewing.

**Step 2:** Repeat Step 1, for each *Paper #1 to #4, Bag #L1*. Make sure you use the correct strips.

**Step 2**

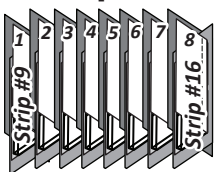

**Step 3:** Fold open the paper and sew on Line 1. Complete the sewing on all (8) *Foundation Sheets*.

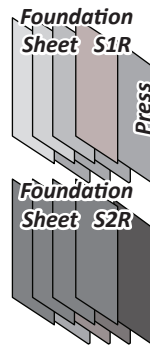

**Step 4**

**Step 4:** When the sewing is complete, flip the papers over and press the fabric as shown on the backside of each paper.

► **Round 2: Fabrics RB1, 3, 5, 7, and S4**

**Strips #9 to #16:**

1. Place Fabric RB1, Strip 9 under Paper #1 Sheet S1R, Sec 2.
2. Place Fabric RB3, Strip 10 under Paper #2 Sheet S1R, Sec 2.
3. Place Fabric RB5, Strip 11 under Paper #3 Sheet S1R, Sec 2.
4. Place Fabric RB7, Strip 12 under Paper #4 Sheet S1R, Sec 2.
5. Place Fabric S4, Strip 13 under Paper #5 Sheet S2R, Sec 2.
6. Place Fabric S4, Strip 14 under Paper #6 Sheet S2R, Sec 2.
7. Place Fabric S4, Strip 15 under Paper #7 Sheet S2R, Sec 2.
8. Place Fabric S4, Strip 16 under Paper #8 Sheet S2R, Sec 2.

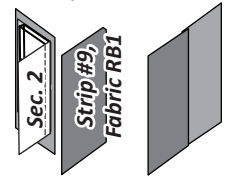

■ **PART 2: TRIMMING AND CUTTING THE PAPERS**

**Step 1:** When the piecing is finished, the excess fabric and paper is trimmed off along the exterior edges on each foundation sheet.

**Step 2:** There are two solid lines printed around the perimeter of each Foundation Sheet. The outside line is the trim line.

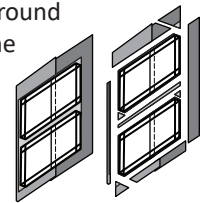

**Step 3:** Finish trimming around the perimeter of each Foundation Unit. Trim away all the excess hatching around the edges. Then trim the smart corners.

**Step 4:** Clip the pieces for each group together and place back into their assigned bags until you are ready to assemble the diamonds.

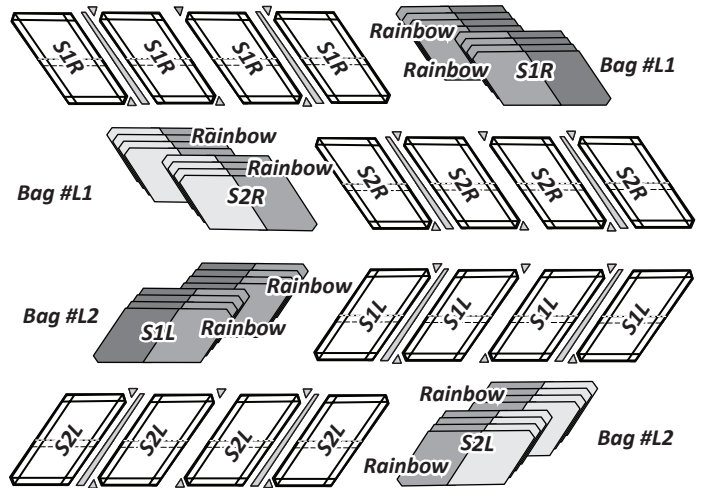

■ **FOUNDATION PIECING BAG #2, S1L & S2L**

► **Round 1: Fabrics S1, RB2, 4, 6, and 8**

The piecing process is the same for *Foundation Sheets S1L & S2L*. We have added a few graphics to get you started.

1. Pair Fabric S1, Strip #1, to Paper #1, Sheet S1R, Sec 1.
2. Pair Fabric S1, Strip #2, to Paper #2, Sheet S1R, Sec 1.
3. Pair Fabric S1, Strip #3, to Paper #3, Sheet S1R, Sec 1.
4. Pair Fabric S1, Strip #4, to Paper #4, Sheet S1R, Sec 1.
5. Pair Fabric RB2, Strip #5 to Paper #5, Sheet S2R, Sec 1.
6. Pair Fabric RB4, Strip #6, to Paper #6, Sheet S2R, Sec 1.
7. Pair Fabric RB6, Strip #7, to Paper #7, Sheet S2R, Sec 1.
8. Pair Fabric RB8, Strip #8, to Paper #8, Sheet S2R, Sec 1.

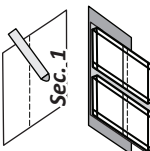

■ **ASSEMBLE THE DIAMONDS**

**Step 1:** Arrange the colors for each strip into the order they will be sewn together. One, each, of Rows 1, & 2 are joined to complete (16) diamonds. There are (2) Right and (2) left of each color group 1-4. Group 1 is shown as an example below. For a reminder on Groups 2 to 4, refer to page 16.

