

**Step 1:** Place the templates for Unit G4, cut from Fabric G8 in Bag #G2 with their associated foundation papers.

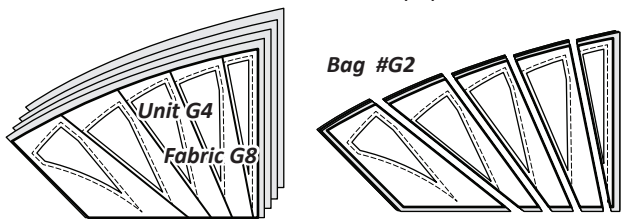

**Step 2:** Place the templates for Unit G4, cut from Fabric G9 in Bag #G3 with their associated foundation papers.

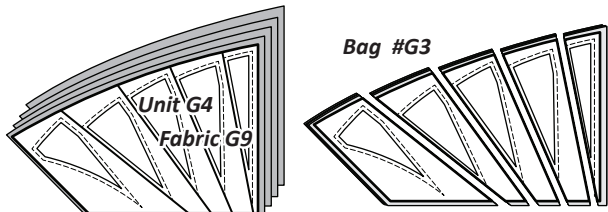

► **Fabric G10: (TLS #13 & #14)**

**Step 1:** Cut (2) 7" by 42" strips from Fabric G10 and place on your table facing *right-side up*. Repositionable fabric glue is applied to the backside of each Unit G3, (TLS) #13 and Unit G4, (TLS) #14. The backside of each layout sheet is then placed against the *right-side* of the fabric. (2) ea. (TLS #13 & #14) are positioned onto each strip.

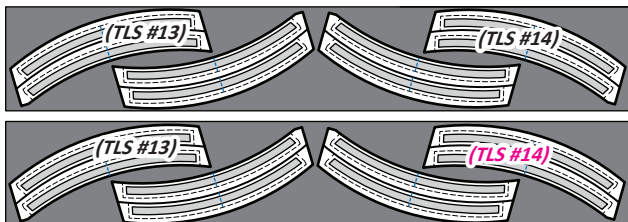

**Step 2:** Cut around each layout sheet leaving about 3/16" of excess fabric along each edge. Set your stitch length at 2.5 and sew the (TRP) Lines on each layout sheet.

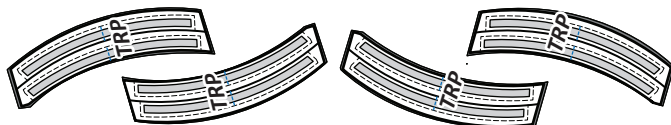

**Step 3:** After the (TRP) lines are sewn, trim the threads on the front and backside of each fabric section, then trim the excess fabric off around the perimeter of each Sec. Temp.

**Step 4:** Cut on Cut Line 1 to separate the templates into individual pieces. Templates G3-10 are placed with Unit G3 in Bag #G2 and Templates G4-10 with Unit G4 in Bag #G3.

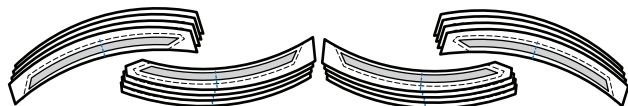

► **Fabric G11: T-Templates G1, G2, G3, & G4**

**Step 1:** Cut (4) 12" by 42" strips from Fabric G11. Stack the strips facing *right-side up*. Position the (4) T-Templates labeled G1 thru G4 onto your strips as shown. Cut (4) pieces matching the size and shape of each template. Repositionable glue placed on the backside of each template will keep the paper from moving as you complete your cutting. When the cutting is completed mark or sew the TRP Lines on each template. Place these pieces into Bag #G4.

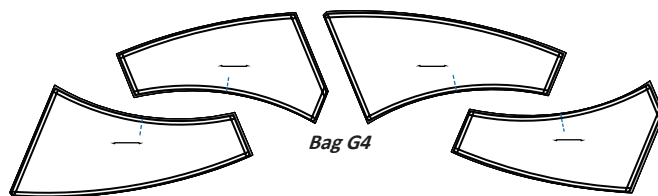
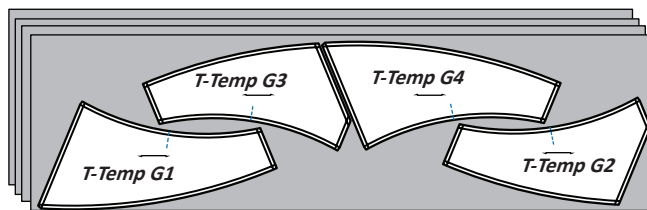

**STACKING: UNITS G1 & G2, BAG #G1**

**Sorting:** The section templates are paired up with the Sec #s printed on the foundation papers for each unit.

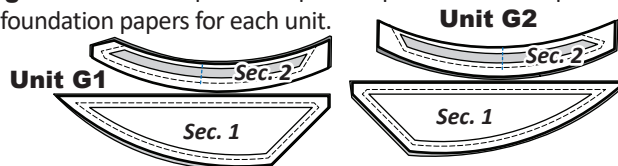

**Step 1 CURVED PAPER PIECING**

NOTE - Graphic created with Unit G1.

**Step 1:** Place a small amount of fabric glue on the backside of each foundation paper under Sec. 1.



**Step 2:** Position the first piece of fabric for Sec. 1 *wrong-side up* on your table. Lift the foundation paper, and slide the fabric under Sec. 1 on each foundation unit. The glue is used to adhere the fabric to the backside of the paper.

**Step 3:** Set stitch at 2.5 and sew on Basting Stitch Line 1, then the TRP Line. Trim the threads on the front and backside of each paper. Note: If you have not sewn the TRP Lines on the veins (TLS #1 and TLS #2), Temp G1-2 & G2-2, please do so at this time.



**Step 4:** Position Unit G1, fabric-side up on your table. Remove the paper on Temp G1-2 and place *wrong-side up* on the top of Unit G1.

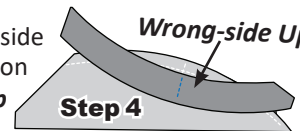

**Step 5:** Match and pin the TRP Lines at the center, then glue the raw edge of Temp G1-2 along the basting stitch to secure the edges.

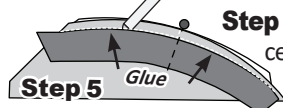

**Step 6:** The curved piecing is completed by sewing on Sew Line 2. There are two options on how to complete the seam.

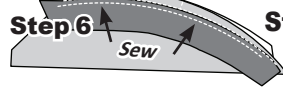

**Option One:** Sewing directly on the sew line. Position the fabric with the paper facing up, fabric on the bottom. To avoid sewing puckers into the seam, lift the paper about 1/2" and hold it slightly above the surface of the machine as you sew on the stitch line. This allows the fabric to move freely as it passes over the feed dogs on your machine.

**Option two:** Sewing directly on the fabric. The paper is placed next to the feed dogs, fabric facing up. The edge of your quarter-inch presser foot is aligned with the basting stitch to achieve a 1/4" seam allowance.