

## GROUP B: CHRISTMAS GOOSE

**Ziploc Storage Bags:** You will need (1) bag to complete the organization for these instructions. Label the bags as follows to stay organized while cutting the Foundation Units and Templates.

- Bag #B1: (8) Unit B1 Foundation Papers and Cutting Templates

### ► Preparing the Foundation Papers:

**Step 1:** Cut out (8) of Unit B1 [NP 720], along with (2) of each Template and (TLS) [TP 539] and place everything in Bag #B1. See the newsprint graphics that follow for information on how to organize your units and templates into bags. \*Refer back to General Information for Foundation papers and templates for additional instructions on how to prepare your foundation papers and templates.

#### ► (1) NP 720

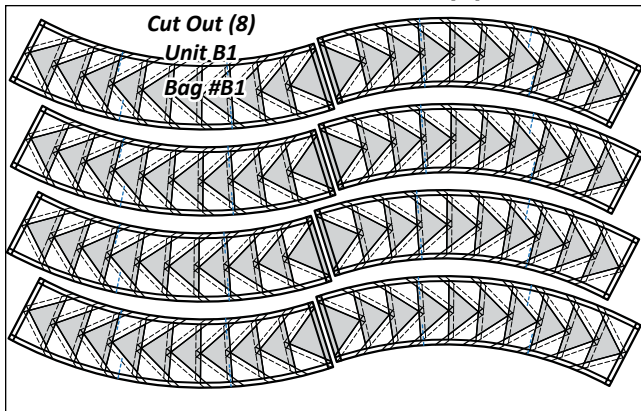

#### ► (1) TP 539

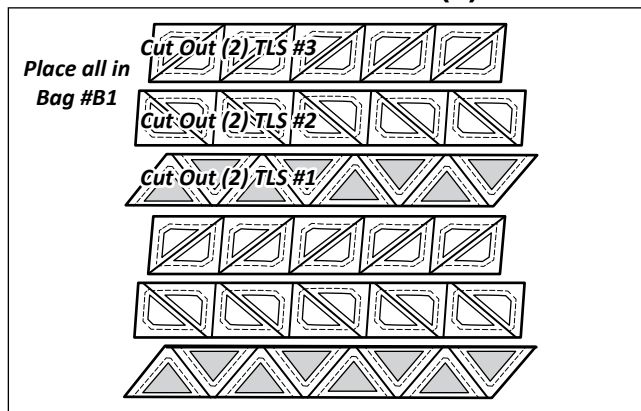

### ► Christmas Goose Fabric Information:

The table in the next column includes yardage, fabric numbers, and a reference to which fabrics go with the T-Templates, Templates, & (TLS) to complete Units in Group B. It is your guide for not only selecting your own colors, but staying organized. Don't forget to cut and paste a swatch of the chosen fabric in the Assigned Colors column! Color layouts for the various options are included below.

### ► Color Layout

**NOTE - Front-side-view:** This is how the fabric is laid out, looking at the right-side of the quilt.

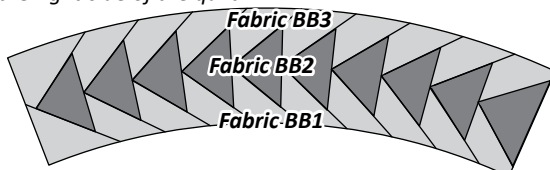

### Unit B1, Make (8)

GROUP-B FABRIC #	YARDAGE INCH	ASSIGNED COLOR
Fabric BB1 Unit B1 TLS #3	3/8 yd or (12")	Fabric Swatch
Fabric BB2* Unit B1 TLS #1	1/2 yd or (15")	Fabric Swatch
Fabric BB3 Unit B1 TLS #2	3/8 yd or (12")	Fabric Swatch

**NOTE - \*Fabric BB2:** Quiltster gives you the option to use (5) different fabrics for Fabric BB2. If you do this, you will cut (1) 3" strip from (5) different fabrics, for 1/8 yard of each. Label your fabrics BB2:a, BB2:b, BB2:c, BB2:d, and BB2:e.

### ► Fabric BB1: Unit B1 (TLS #3)

**Step 1:** Cut and stack (4) 3" by 42" strips facing *right-side-up*.



**Step 2:** The *Unit B1 Template B1-3 Layout Sheet #3* is used to cut (8) pieces, (2) from each strip of fabric, matching the size and shape of the (TLS).



**Step 3:** Stack into (2) stacks of (4) pieces, and place (1) TLS #3 on top of each stack. Paper clip the individual sections to the fabric beneath. The cutting is completed by slicing through the paper on each cut line in numerical order to separate the individual sections.



**Step 4:** Place the fabric pieces into Bag #B1.

### ► Fabric BB2: Unit B1 (TLS #1)

**Step 1:** Cut and stack (5) 3" by 42" strips facing *right-side-up*.



**Step 2:** The *Unit B1 Template B1-1 Layout Sheet #1* is used to cut (8) pieces, (4) from each strip of fabric, matching the size and shape of the (TLS).



**Step 3:** Stack into (2) stacks of (4) pieces, and place (1) TLS #1 on top of each stack. Paper clip the individual sections to the fabric beneath. The cutting is completed by slicing through the paper on each cut line in numerical order to separate the individual sections.

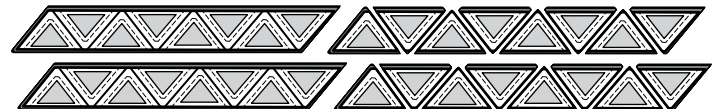

**Step 4:** Place the fabric pieces into Bag #B1. If you used (5) different fabrics, sort each fabric into (2) stacks of (8) and label them BB1:a to BB1:e, in the order you want to sew them.

## ► Fabric BB3: Unit B1 (TLS #2)

**Step 1:** Cut and stack (4) 3" by 42" strips facing *right-side-up*.



**Step 2:** The *Unit B1 Template B1-2 Layout Sheet #2* is used to cut (8) pieces, (4) from each strip of fabric, matching the size and shape of the (TLS).



**Step 3:** Stack into (2) stacks of (4) pieces, and place (1) TLS #2 on top of each stack. Paper clip the individual sections to the fabric beneath. The cutting is completed by slicing through the paper on each cut line in numerical order to separate the individual sections.



**Step 4:** Place the fabric pieces into Bag #B1.

## STACKING: UNIT B1

Position the templates and fabric pieces in numerical order facing *right-side up*, with the *sew-sides* aligned at the top. You will want to have (2) stacks of (4) in each section stack for a total of (8) pieces for each section. The hatched blocks (for the geese) are labelled as Temp B1-1 and do not have a Sec. 1. You will start with a Temp B1-1 as Sec. 1 and then repeat this section stack every 3rd section. If you are using (5) different fabrics, start with Fabric BB1:a for Sec. 1 & 16, BB1:b = Sec. 4 & 19, BB1:c = Sec. 7 & 22, BB1:d = Sec. 10 & 25, and BB1:e = Sec. 13 & 28. The remaining fabric stacks will be labelled with a Sec. #.

**Stacking:** The stacking process begins with the largest Sec. # on the bottom. The pieces are stacked in reverse order finishing with Sec. 1 on top.

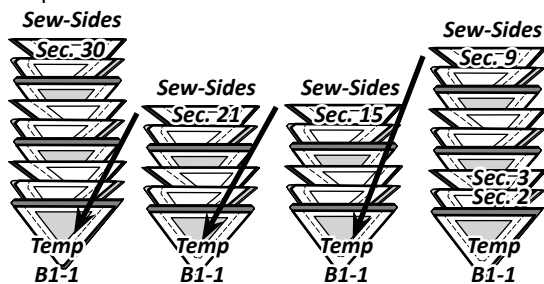

## FOUNDATION PAPER PIECING: UNIT B1

**NOTE - Tracing the Dashed Lines:** Place the foundation paper onto a light table. Flip the foundation paper over and trace the dashed lines printed on the front side of the foundation paper, onto the backside of the paper.

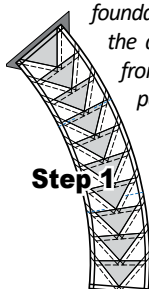

**Step 1:** The first piece of fabric is placed *wrong-side-up* on your table. Lift the foundation paper, slide the fabric under Sec. 1. Glue is used to adhere the fabric to the backside of the paper. Repeat Step 1 for each foundation unit.

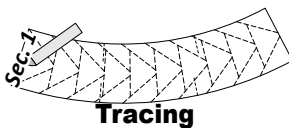

**Step 2:** Place the fold template over the top of Sec. 1. Line the edge up with the solid black line marked *Line 1*.

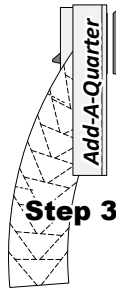

**Step 3:** Fold the paper back over the top of the fold template.

**Step 4:** Place the *Add-A-Quarter* ruler next to the folded paper and trim the fabric with your rotary cutter.

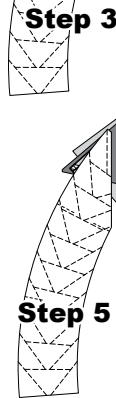

**Step 5:** Place the fabric piece for Sec. 2, *right-side-up* next to the folded back paper. Lift the paper, and slide the fabric under Sec. 1, line the sew-side up with the trimmed seam allowance. Repeat **Steps 1-5** for each foundation paper before moving onto Step 6.

**Step 6:** Sew on Line 1. The stitches should start and stop about 1/8" past the beginning and the end of each stitch line. Complete the sewing on each Unit before moving onto the next step.

**NOTE - Trimming the Threads:** Sewing past the ends of your sew line makes it possible to cut the thread ends off each time you trim with your *Add-A-Quarter* ruler.

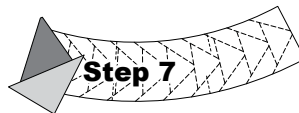

**Step 7:** Loosen the glue under Sec. 1, then press the fabric pieces open on the backside of each paper.

**Step 8:** Position the fold template over the top of Sections 1 and 2, lining the edge up with Line 2. Fold the paper back and tear the paper along the stitches on Line 1. Stop tearing when you hit the fold template.

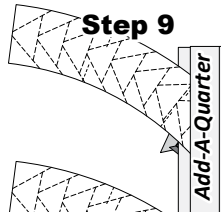
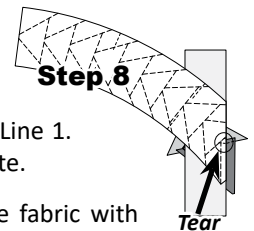

**Step 9:** Trim the fabric with the *Add-A-Quarter* ruler, position the third fabric piece *right-side-up* next to the paper. Lift the paper and slide the fabric under Sec. 3 in position. Then open the paper, sew on Line 2, press.

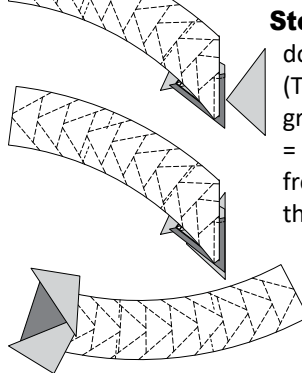

**Step 10:** When the paper piecing is done, the sewing is completed on the (TRP) Lines, which are shown in the graphic in white (minimum stitch length = 2.8). The threads are trimmed on the front and backside of the paper, then the excess fabric and paper is trimmed off around the perimeter of the exterior dark line printed on the foundation paper. Do not remove the foundation paper at this time. Place the pieces into Bag #B1.

