

Step 11: Trim the fabric with the *Add-A-Quarter* ruler. Position the third fabric piece *right-side up* next to the paper. Lift the paper and slide the fabric under Sec. 3 in position.

Step 12: Open the paper, sew on Line 5 and press.

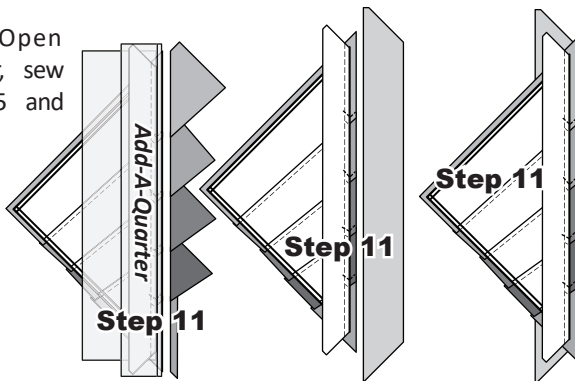

► **Unit D6**

Step 1: Repeat the previous steps to complete the Foundation Paper piecing for Unit D6.

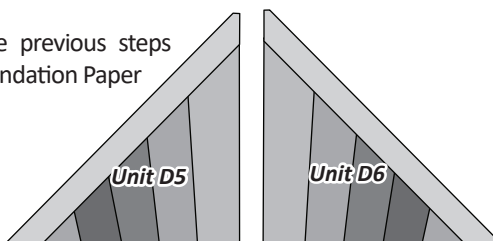

► **Transition & Registration Points**

When you are done with the paper piecing for both units, the TRP lines are sewn on each unit using a basting stitch with a minimum stitch length of 2.8. The registration lines are used to center Units D5 and D6 up with the New York Beauty border units. Trim off the excess fabric and paper using the exterior solid line on each foundation unit as your trim line.

NOTE - Foundation Papers: The foundation papers are not removed until you are ready to assemble your quilt.

► **Assemble the Border Units**

The foundation paper is removed from the backside of each unit at this time. Refer back to the general instructions for additional information on removing the foundation paper.

Step 1: Place the pieces on a design wall according to the Step 1 graphic.

Step 2: Unit D1 and D2 are sewn together and Units D3 and D4 are sewn together. The seams are pressed towards Unit D1 and D3.

Step 3: Unit D6 is sewn onto Unit Group D3/D4 and Unit D5 is sewn onto Unit Group D1/D2.

Step 4: The two corner Units are joined to complete (4) large Corner Groups. The seam is pressed towards Unit D1.

