

► **Fractured Star Fabric Information:**

The following table includes yardage, fabric references, and a space for a fabric swatch. We have also paired the Unit and Templates names up with the fabric reference #s. Below the Fabric Chart we have added a Fabric Layout showing the location of each Fabric # on the Foundation Unit. If you are using the precut strip sets no Fabric Swatches are required for Fabric B4.

Unit B Foundation Sheets and T-Templates		
FABRIC #	YARDAGE INCH	ASSIGNED COLOR
Fabric B1 T-Templates CL1-CL3 & CR1-CR3	2-1/2 yd or 90"	FABRIC SWATCH
Fabric B2 T-Template C4 and C5	1-1/4 yd or 42-3/4"	FABRIC SWATCH
Fabric B3 Unit B Accent SP Template	3/8 yd or 13-1/2"	FABRIC SWATCH
Fabric B4 Unit B Background SP Template	5/8 yd or (8) 2-1/2" Strips	FABRIC SWATCH

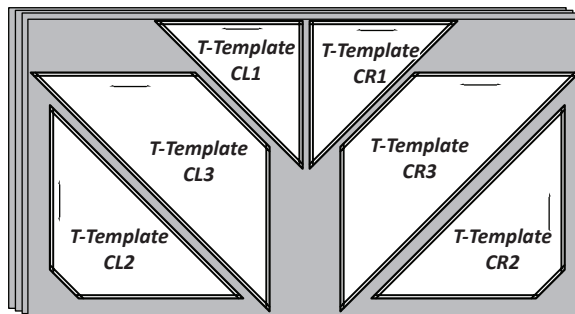

► **Fabric B3**

**Step 3:** Cut (8) 1-1/4" x 42" strips from Fabric B3, open and stack the strips facing *right-side-up*. Use the **Unit B Accent Strip Piecing Template** and cut (32) pieces. Clip the pieces together and place into Bag #B1.



► **Fabric B2**

**Step 4:** Cut (9) 4-3/4" x 42" strips. Facing *right-side-up* make (1) stack with (7) strips, and (1) stack with (2) strips.

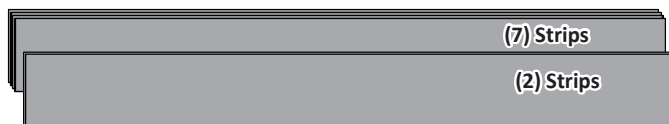

**Step 5:** Place **T-Template C5** on the stack with (7) strips, and **T-Template C4** on the stack with (2) strips.

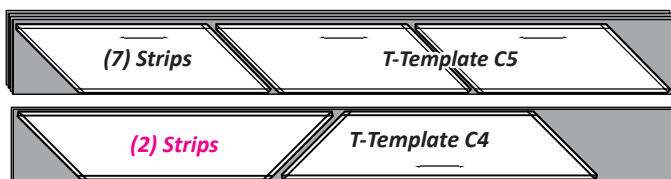

**Step 6:** Cut the templates out. Place (20) **T-Template C5** and (4) **T-Template C4** into the Bag #B2.

► **Fabric Group B4:**

**Step 7:** Open and stack the (8) strips facing *right-side-up* in Bag #B1. The stacking order is important for these strips. The strips are arranged by color as shown in the graphic on the following page. The stacking starts with Fabric B4:h on the bottom and ends with B4:a on the top. When you are done cutting the template pieces, set aside the left over pieces off the ends of each strip. These pieces [fabric swatches] are cut and glued onto the foundation papers to help keep you from sewing the wrong strips onto your foundation papers.

**Fabric Collection:** You will need (8) 2-1/2" by 42" strips to complete the Diamond Border. If you are using the precut Quiltworx **Strips Sets** use the (8) strips set aside earlier for the diamond border templates. If you are choosing your own colors, you need to cut (8) 2-1/2" strips from your chosen fabrics at this time. Labeled the strips at this time as Fabric Group B4 and place in Bag #B1.

Fabric Group B4: Bag #B1  
Choose (8) strips.

► **CUTTING THE BORDERS, BAG #B2**

► **Fabric B1**

**Step 1:** Cut (4) 22-1/2" x 42" strips from Fabric B1. Stack these *right-side-up* on your cutting table.

**Step 2:** Use **T-Templates** CL1, CL2, CL3, CR1, CR2, and CR3. Position these on your fabric as shown. Flower pins work great for pinning the templates to the fabric. A ruler and rotary cutter are used to cut your pieces. After the templates are cut, clip the templates to the fabric pieces and place into Bag #B2.

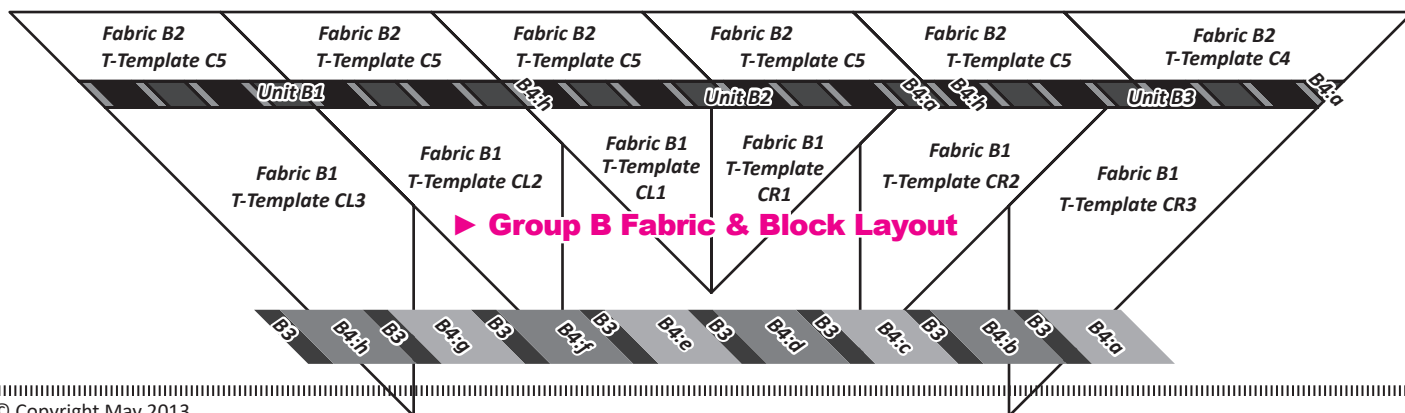

**Step 7:** Lift the foundation paper, slide the fabric under Sec. 2 lining the sew-side up with the trimmed seam allowance. Make sure the fabric extends beyond the boundaries of the dashed lines for Sec. 2.

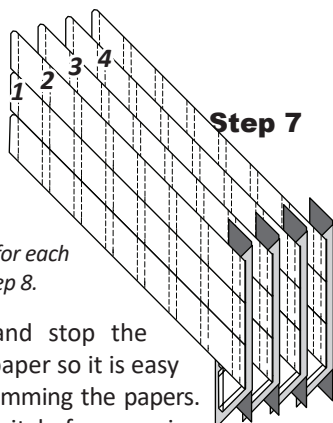

**NOTE - Chain Piecing:** Repeat steps 4-7 for each foundation paper before moving onto Step 8.

**Step 8:** Sew on Line 1. Start and stop the stitches just past the edge of the paper so it is easy to cut the thread ends off when trimming the papers. Complete the sewing on each Unit before moving onto the next step.

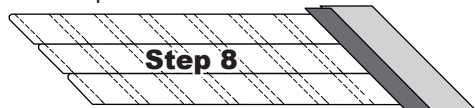

**Step 9:** Loosen the glue under Sec. 1. Then press the fabric on the backside of each paper.

**Step 10:** Continue with the foundation paper piecing, repeating the previous steps, as you add each piece to the foundation paper.



## TRIMMING AND CUTTING THE PAPERS

**Step 1:** Place each foundation sheet on your table with the paper side up. Trim the excess fabric and paper off along the long edges of each foundation sheet. There are two solid lines printed around the perimeter of each sheet. The outside line is the trim line.

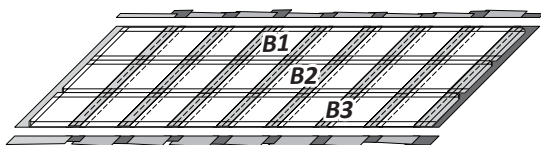

**Step 2:** Find the two lines referred to as **Part 2 Cut Line 1 & Part 2 Cut Line 2**. These are your cutting lines. Using your ruler and rotary cutter, cut each line to separate the three rows.

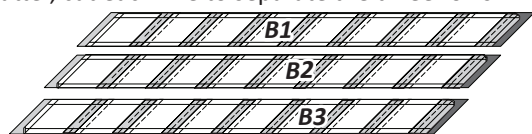

**NOTE - Make sure before you cut you are cutting on the correct lines. If you mis-cut these lines you will end up making the borders over.**

**Step 3:** Next trim the edges off both ends, then trim off the tips to complete the cutting for all the smart corners.

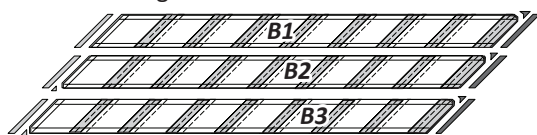

**Step 4:** Clip the (3) Units B1, B2, & B3 together and set aside. Repeat Steps 1-4 for each sheet.

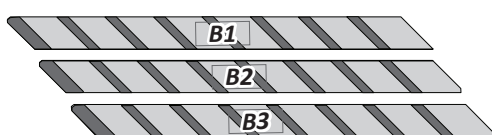

## ASSEMBLE THE BORDER

**Step 1:** Arrange the border Units on your design wall as shown. Graphics show the front side of the units from this point forward.



**Step 2:** Sew Together (2) T-Template C5 groups and (1) T-Template C4/C5 group as shown. Press the seams in the direction shown by the arrows.

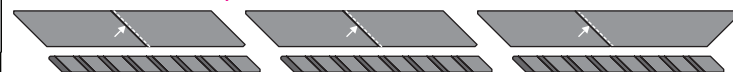

**Step 3:** Join Units B1, B2, and B3 to the T-Templates as shown below. After Joining Unit B3 to T-Template C5 and C4, use a straight ruler to trim Unit B3 at the same angle as T-Template C4. Complete this step on each side.

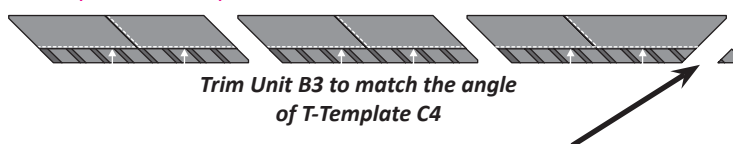

**Step 4:** Sew together the final seams between each of the (3) border sections on each side. The final seams should be pressed in the direction of the arrows shown below.

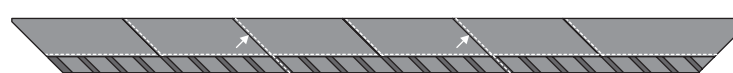

## ASSEMBLE THE STAR

**Step 1: Illustration 1:** Arrange the Units on your Design Board. For the cover quilt, we place all the light points facing toward the center. Other samples have been made with all the light points pointing out, and some have a combination. It's up to you. You can arrange your blocks however you like! Quiltster gives you the ability to explore different options if you want to see what it looks like before you decide. Graphics that follow show the front side of the quilt.

### ► Illustration 1: Layout

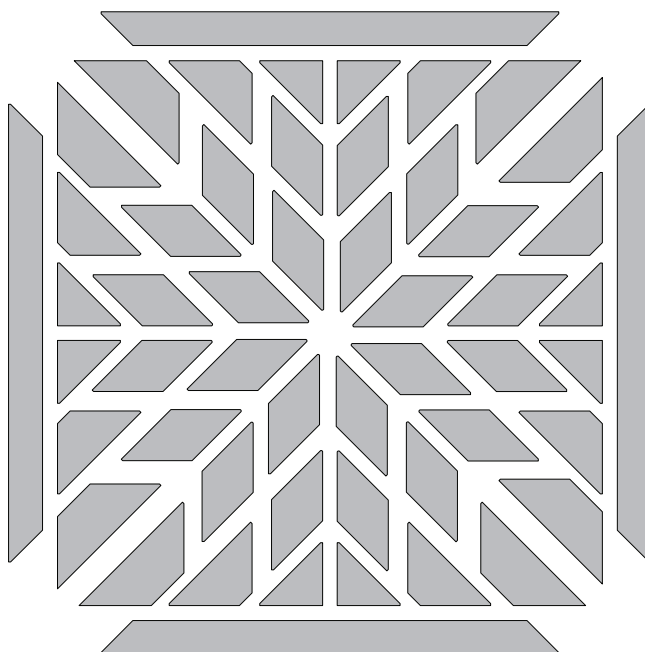

**Step 2: Illustration 2:** The units are joined in strips as shown. The seams are pressed in the direction of the arrows. The border sections are joined and press in the direction of the arrows.

► **Illustration 2: Rows**

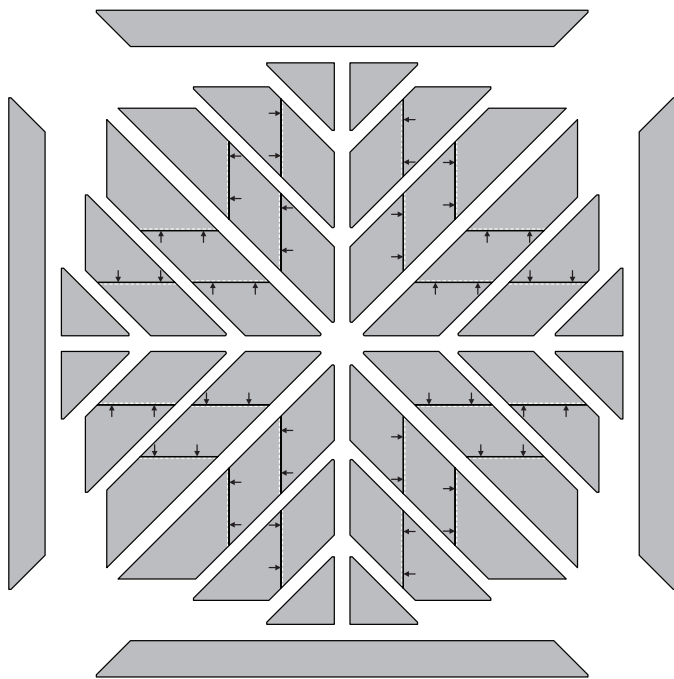

**Step 3: Illustration 3:** Join the rows in numerical order to complete (8) triangles. Press all seams as shown.

► **Illustration 3: Triangles**

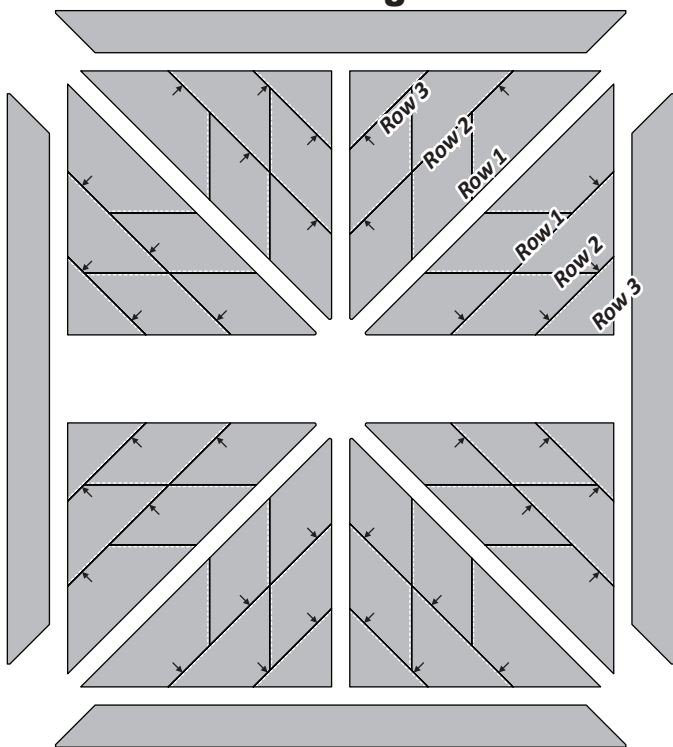

**Step 4: Illustration 4:** Join the small triangles to complete four larger triangles.

► **Illustration 4: Large Triangles**

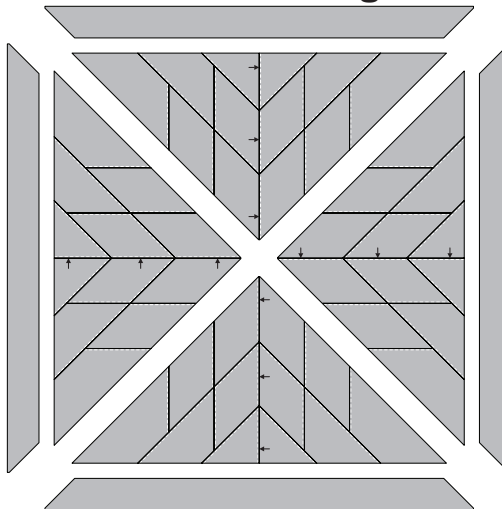

**Step 5: Illustration 5:** The four border units are joined with the four large triangles. Press the seams in toward the center.

► **Illustration 5: Large Triangles**

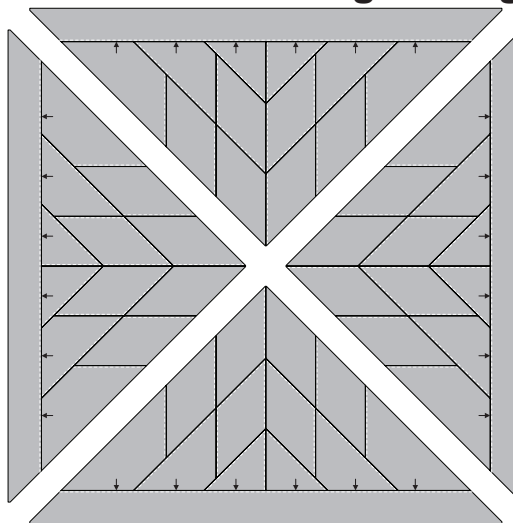

**Step 6: Illustration 6:** Two large triangles are joined to complete two half sections. Press all seams as shown.

► **Illustration 6: Half Sections**

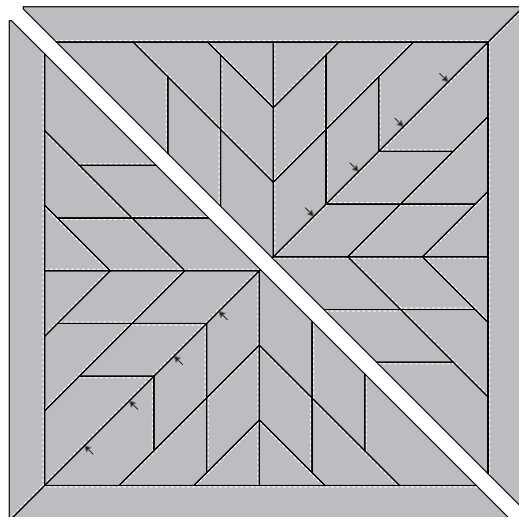

**ACKNOWLEDGEMENTS**

Paper Piecing Units Designed by: Brad and Judy Niemeyer  
 Colorway by: Judy and Judel Niemeyer  
 Fabrics by: Heirloom (48) Piece 2-1/2" Strip Set from Timeless Treasures  
 Pieced and Quilted by: Quiltworx.com