

**Step 1:** Fabric Swatches from each color are cut and pasted onto each foundation sheet as shown below.

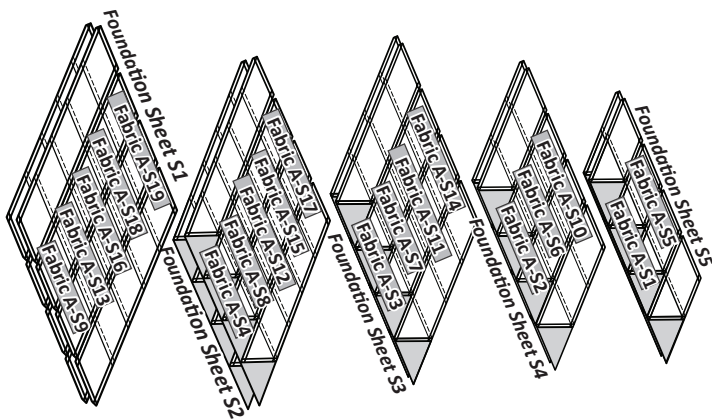

► **Stacking Order**

The Foundation Sheets are rotated and stacked starting with (2) each of Foundation Sheet S1 on the bottom ending with (2) each Foundation Sheet S5 on the Top. Number your papers 1-10 starting with Foundation Sheet S5 on the top. If you don't number the papers you will lose track of where you are in the instructions.

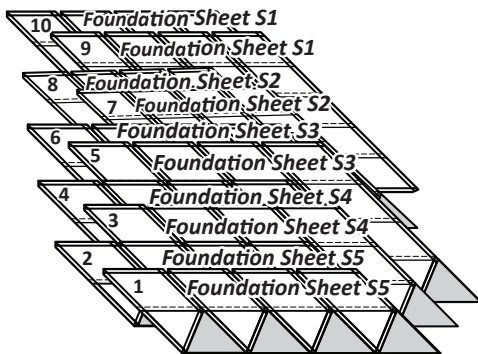

■ **FOUNDATION PAPER PIECING BAG:  
FOUNDATION SHEETS S1 TO S5**

► **Round 1: Strips 1-8**

The graphic to the right is repeated from Page 11, Step 4. The strips in the first round are glued onto the backside of each Foundation Sheets S1, S2, S3, & S4.

- (2) each Fabric A-S4, Strips #7 & #8
  - (2) each Fabric A-S3, Strips #5 & #6
  - (2) each Fabric A-S2, Strips #3 & #4
  - (2) each Fabric A-S1, Strips #1 & #2
- Round-1, Strips 1-8

1. Pair Fabric A-S1, Strip #1, to Foundation Sheet S5, Sec 1
2. Pair Fabric A-S1, Strip #2, to Foundation Sheet S5, Sec 1
3. Pair Fabric A-S2, Strip #3 to Foundation Sheet S4, Sec 1
4. Pair Fabric A-S2, Strip #4 to Foundation Sheet S4, Sec 1
5. Pair Fabric A-S3, Strip #5 to Foundation Sheet S3, Sec 1
6. Pair Fabric A-S3, Strip #6 to Foundation Sheet S3, Sec 1
7. Pair Fabric A-S4, Strip #7 to Foundation Sheet S2, Sec 1
8. Pair Fabric A-S4, Strip #8 to Foundation Sheet S2, Sec 1

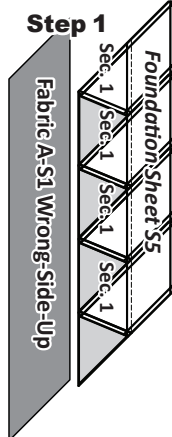

**Step 1:** Place Strip #1 [Fabric A-S1] *wrong-side-up* on your table along the edge of *Foundation Sheet S5* as shown. Find the diamonds on the foundation paper labeled as Sec. 1. Place a small amount of fabric glue on the backside of the paper under Sec.

1. Lift the foundation paper, slide the fabric under the Section 1 Diamonds and adhere the paper to *wrong-side* of the fabric. Repeat Step 1 for each *Foundation Sheet S5, S4, S3, and S2*.

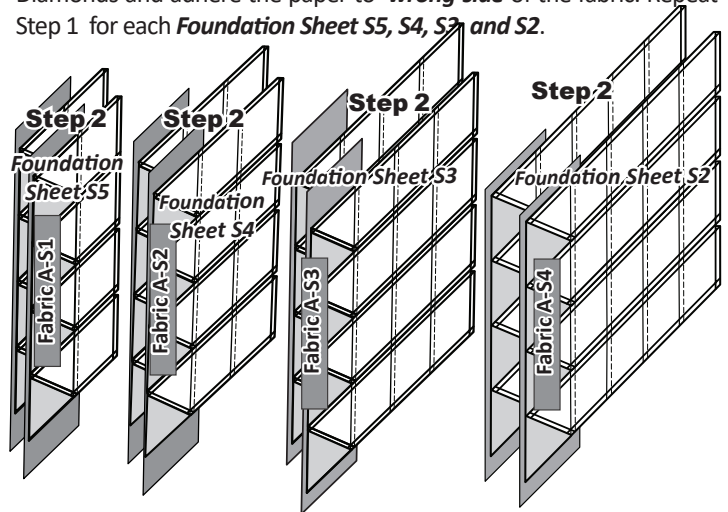

**Step 2:** Start with *Foundation Sheet S2*, place the fold template over the top of Sec. 1, lining the edge up on the solid black line marked Line 1.

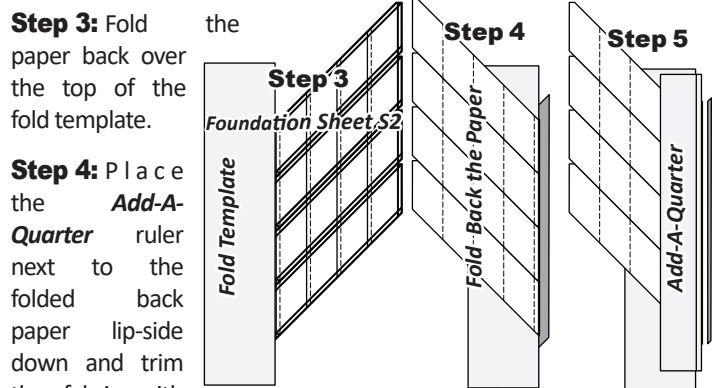

your rotary cutter. This leaves you with a quarter-inch seam allowance which, is lined up with the next strip of fabric.

**Step 5:** Repeat the trimming process in the previous Steps 3-5 on each *Foundation Sheet S5, S4, S3, and S2*. Stack the papers as you trim starting with Paper #8 on the bottom, ending with Paper #1 on the top as shown on the right.

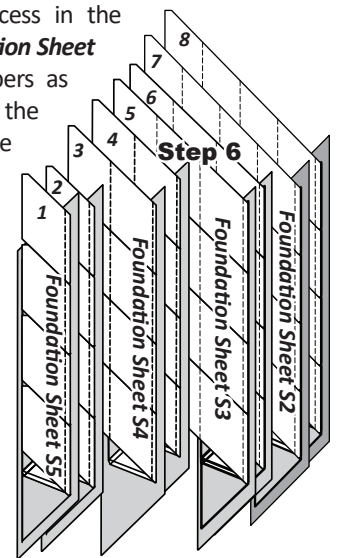

► **Round 2: Strips 1-10**

**Strips 1-8:** Round 2 strips 1-8 are positioned under the Sec. 2 diamond on each *Foundation Sheet* labeled *S2-S5*.

**Strips 9-10:** Round 2 strips 9-10 are placed wrong-side-up under the Sec. 1 Diamonds on the backside of both *Foundation Sheets S1*. These strips are not sewn until Round 3.

1. Pair Fabric A-S5, Strip #1, to Foundation Sheet S5, Sec 2.
2. Pair Fabric A-S5, Strip #2 to Foundation Sheet S5, Sec 2.
3. Pair Fabric A-S6, Strip #3 to Foundation Sheet S4, Sec 2.
4. Pair Fabric A-S6, Strip #4 to Foundation Sheet S4, Sec 2.
5. Pair Fabric A-S7, Strip #5 to Foundation Sheet S3, Sec 2.