



7. Pair Fabric S24, Strip #7 to Foundation Sheet S4, Sec 5.
8. Pair Fabric S24, Strip #8 to Foundation Sheet S4, Sec 5.
9. Pair Fabric S25, Strip #9 to Foundation Sheet S5, Sec 5.
10. Pair Fabric S25, Strip #10 to Foundation Sheet S5, Sec 5.

Step 1: Repeat the same process as described for Round 2 to add the Round 5 strips.

PART 2: TRIMMING AND CUTTING THE PAPERS

When the piecing is finished, the excess fabric and paper is trimmed off along the top and bottom edge of each foundation sheet. There are two solid lines printed around the perimeter of the paper. The last line that borders the edge of the foundation sheet is the trim line.

Step 1: Place each foundation sheet on your table with the *paper-side-up*. *Foundation Sheet S1* is shown for demonstration purposes.

Step 2: First, trim the edges off the top and bottom, then sides of each Foundation Sheet on the exterior solid lines.

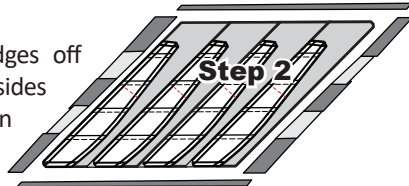

Step 3: Foundation Sheets

S1 and S3 have Registration Lines on them that must now be marked with your machine and a basting stitch before moving to Step 4. Skip to Step 4 for Foundation Sheets S2, S4, and S5 since they do not have Registration Lines. Take the trimmed Sheets to a sewing machine. Set the stitch length to 2.8 and find the registration lines (a dotted line located along Sec. 3 of each Unit on Foundation Sheet S1 and along Sec. 1 of each Unit on Foundation Sheet S3). Sew a basting stitch along each dotted line, lifting the presser foot and moving to the next line until you have stitched them all. If you sew these in before you cut the Units apart, you will be able to trim the excess string along the way.

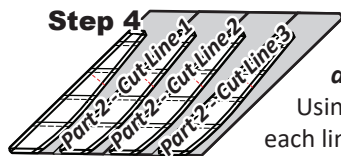

Step 4: Find the three lines referred to as *Part 2 Cut Lines 1, 2, and 3*. These are the cutting lines. Using a ruler and rotary cutter, cut each line to separate the four rows.

Step 5: Next, trim off the tips to complete the cutting for all the smart corners. Each of the units in this lone star design have some curved edges that all need to be trimmed. Trim away all of the scrap. The resulting unit is called Unit S1, Row 1.



Step 6: Clip the pieces for each Unit/Row together and set aside. Repeat Steps 1-4 to complete the remaining Sheets.

ASSEMBLE THE DIAMONDS

Step 1: Arrange the strips into the order shown to the right. One each of *Units S1 to S5* are joined to complete (1) diamond. Fabric reference numbers are shown.

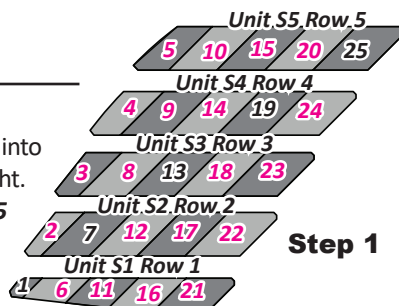

Now is a good time to double check your sewing and Unit placement to make sure you have everything in the right place. Make (8) diamonds consistent with the diagram shown.

NOTE - Making Corrections: If you find you need to fix a color, there is still time. Each piece is now the same size as if it was cut using a diamond template. Pick out the seams, rearrange the diamonds, and sew the pieces back together.

Step 2: Assemble the rows in the order shown in the following steps. Begin by positioning Unit S2 onto the top of Unit S1, with both strips facing *right-sides-together*. Match and pin each intersection where the sew lines cross on the foundation paper.

RIGHT SIDES TOGETHER

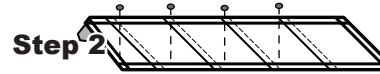

Step 3: Remove the foundation papers from under the diamond sections on the bottom foundation paper without disturbing the pins.

Step 4: Set your Sewing Machine to sew a quarter inch seam.

Step 5: Place Unit S1 on the bottom next to the feed dogs, leaving Unit S2 on top. Both strips are sewn together, using the quarter-inch line as a guide for stitching. The seam is pressed facing towards Row 1 (S1) as shown with the arrows in the assembly diagram below.

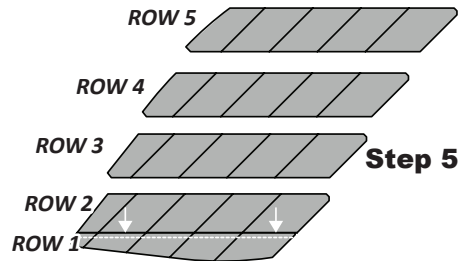

Step 6: Position Unit S3 on top of Unit S1/S2 along the Unit S2/Row 2 edge. Match and pin each intersection where the sew lines cross on the foundation paper.

RIGHT SIDES TOGETHER

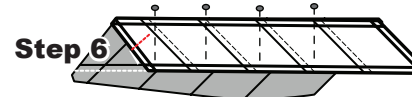

Step 7: Remove the foundation papers from Unit S2 Row 2 without disturbing the pins.

Step 8: Place Unit S2/Row 2 on the bottom next to the feed dogs, leaving Unit S3 on top. Both strips are sewn together, using the quarter-inch line as a guide for stitching. Press the seams facing towards Row 2 as shown with the arrows in the assembly diagram below.

