

CUTTING INSTRUCTIONS FOR BAG #6

Step 1: Remove the (8) 6-1/4" strips for #C11, #C12, #C13, and #C14 (in the case of the cover quilt, these are all cut from the same color, Grass) and stack these, *wrong-side-up*, on the cutting table.

Step 2: Find *Template OB1* in Bag #6 and use it to cut (9) strips, the shape of the template, from the stack of strips. Clip together and place back into Bag #6.

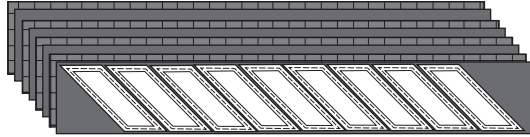

NOTE - If #C11, #C12, #C13, and #C14 are different colors: If these are different colors, simply follow Steps 1 and 2, but sort the pieces by color before clipping them together and placing them back into Bag #6.

Step 3: From the leftover fabric from #C12, cut (8) triangles using Template OB2. Place these back into Bag #6.

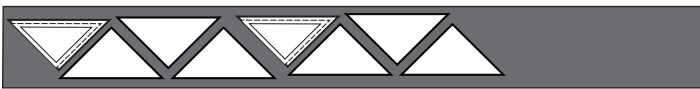

SPECIAL HINTS

Adjusting the Tension, Stitch Length, and Needle Size:

The tension and stitch length on your machine should be adjusted according to the weight of the paper on which you are sewing. Sew a couple practice seams through a few scraps of paper and fabric. Check the tension for even, tight stitches. If the paper is hard to pull away from the fabric, tighten the stitch a bit. If the paper falls apart during the sewing process, loosen the stitch a bit.

Needles: For lightweight paper like newsprint, I use size 70 needles.

Pressing: Most ink used for printing is not permanent if it gets pressed into your fabric, but it can cause a big mess. The ink will wash out of most fabrics but try to avoid this problem by following these guidelines.

1. Always press on the backside of the paper, avoiding the black lines. This will keep the ink off the bottom of the iron. Protect your ironing board by placing a strip of muslin over your board while working on foundation paper.
2. Don't stack the foundation papers on top of each other when pressing the seams. If you do, you may press ink marks into the fabric directly under the piece you are pressing. The best way to avoid this is to press one piece, set it to the side, and then press the next piece. Steam may cause the ink to come off easily and may also shrink the paper a little, so don't use too much steam. A little steam is okay. Just be careful! If the paper curls in the pressing process, turn the temperature down on the iron just a bit and adjust the steam.

Template Pieces: All the template pieces designed for this pattern are bigger than the section they were designed to cover on the foundation paper. If you find a piece does not cover the section it was intended to cover, it means you have done something wrong. It could be one of several things.

1. The fabric piece may have been positioned incorrectly

before sewing it onto the foundation paper.

2. You may have cut out the fabric pieces incorrectly by cutting on the wrong lines.
3. The piece you are working on might be a directional piece and you may have the wrong piece of fabric or you may have cut them out backwards.

Whatever the reason, remember, mistakes can be corrected.

Sew Sides: The template pieces in this pattern are directional. If you don't match the sew-side on a directional piece, you will reverse the piece causing it not to cover the section it was cut for.

STACKING AND SORTING: UNIT H: BAG #1

Remove the Unit H Background and Spike pieces from Bag #1. Before beginning paper piecing, it is helpful to stack the unit pieces in the order in which they are sewn. Line the pieces up, with the templates still clipped to each stack, as shown in the graphic to the left. Make sure the stacks are facing *right-side-up*.

Sew Side Up



Stack the template pieces with the sew-sides aligned at the top, facing *right-sides-up*. When the stacking is complete, Sec. 11 will be at the bottom of the stack and Sec. 1 will be on the top.

Sew Side Up

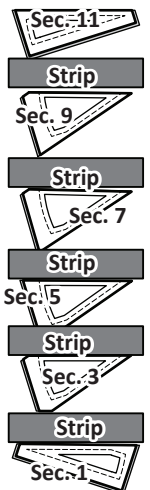

FOUNDATION PAPER PIECING

BAG #1: UNIT-H (MAKE (8) OF COLORWAY #1 AND (4) OF COLORWAY (2):

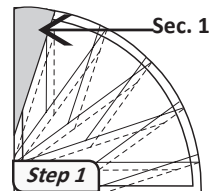

Step 1: Position the *Unit-H* papers *right-side-up* on your table and place a small amount of fabric glue on the *backside* of the paper, under Sec. 1.

Note: When adding the glue to the paper, Make one very light swipe with the glue stick. The glue is used to adhere the fabric to the foundation paper temporarily, until the first two pieces have been sewn to the paper. Then, the fabric should be loosened from the paper.

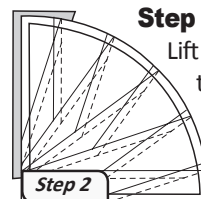

Step 2: Position Fabric #1 *wrong-side-up* on your table. Lift the foundation paper and position Sec. 1 over the top of Fabric #1. Make sure the underneath side of Sec. 1 is covered with the fabric.

Step 3: Place the fold template over Sec. 1. Line the edge of the fold template up to the solid line marked Line 1.

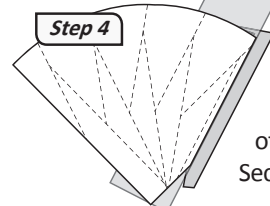
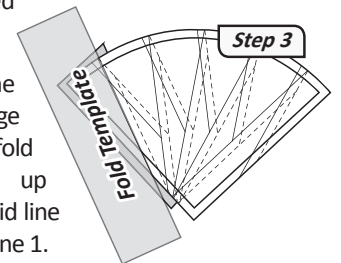

Step 4: Fold the paper back over the top of the fold template. Locate the position of Sec. 2 on the backside of the foundation paper.