

Step 20

Step 20: Press the fabric open on the backside of the paper and trim the foundation papers. Remember, when trimming the foundation paper trim on the solid line around the outer edge of each unit.

NOTE - Do not remove the foundation paper at this time. The paper is used to match the points when sewing Units-A1 and A2 together.

ASSEMBLE UNIT-A1 & UNIT-A2

Units-A1 and A2 are joined to complete (24) snowflakes.

Step 1: Place Unit-A2 on top of Unit-A1 with *right-sides-together*. Match the black dots printed on the foundation papers. Make sure the pin is centered in the middle of both dots on Unit-A and Unit-B. Don't try to match any seams.

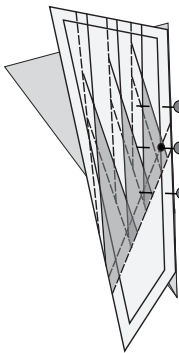

Step 2: Place two (2) additional pin on each side of the intersecting point on Line 1. This will keep the two units from moving as you sew over the seams.

Step 3: Remove foundation paper from the backside of Unit-A1 with out disturbing the pins.

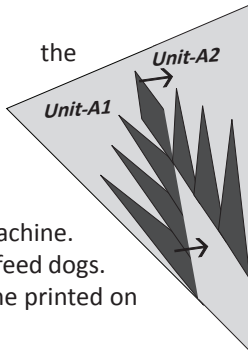

Step 4: Position both pieces at your machine. Place Unit A-1 on the bottom next to the feed dogs. Sew the units together using the 1/4" line printed on Unit-A2 as your sewing line.

Step 5: Remove the foundation paper from Unit-A2 and press the joining seams toward Unit-A2.

NOTE - When you open the seam to press you will notice the seams do not match. Don't worry! The seams were designed not to match.

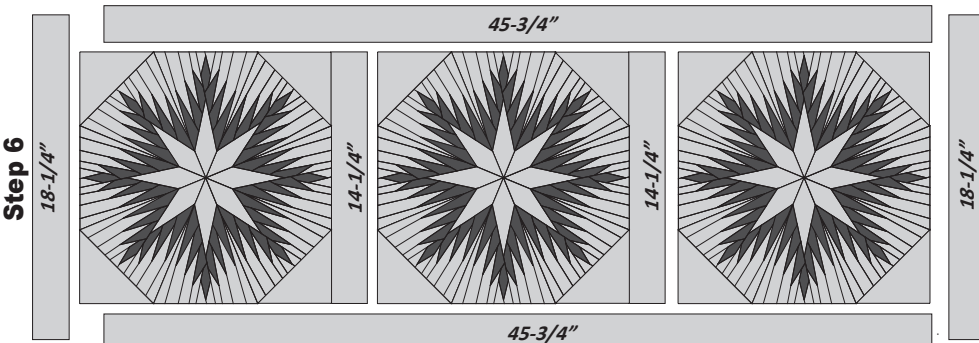
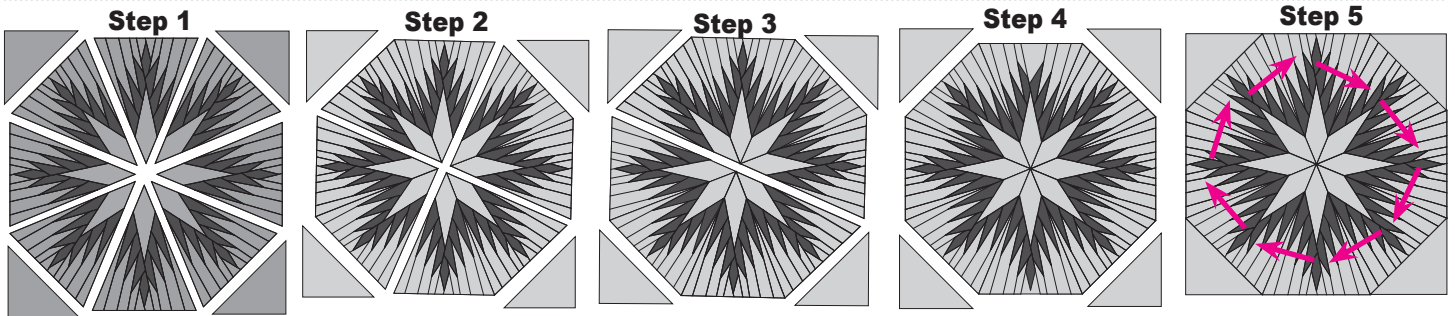

COMPLETE THE CUTTING FOR BACKGROUND FABRIC #B1

- Backing: Cut (1) 22" by 54" piece.
- Binding: Cut (3) 2-1/2" by 54" strips.
- Vertical Borders: Cut (2) 2-1/2" by 45-3/4" strips.
- Horizontal Borders: Cut (2) 2-1/2" by 18-1/4" strips.
- Inner Borders: Cut (2) 2-1/2" by 14-1/4" strips.

Half Square Triangle: Cut (6) 5" squares. Crosscut the squares diagonally into (12) half-square-triangles.

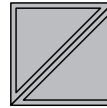

Sewing the Blocks: Graphic Steps 1-5:

Step 1-5(Graphics Below): Follow steps 1-5 below to complete the blocks.

Press the seams counter-clockwise on the *backside* of the fabric (Clockwise on the front) as you sew each seam.

When the blocks are completed, pick back the stitches at the intersection in the center of each star, tweak the seams, and complete the pressing on each block.

The half-square-triangles are sewn on each corner. The seams are pressed facing towards the corner pieces.

Unfinished Block Size: 14-1/4". You may need to square up the block after sewing on the corner pieces.

Step 6: Add the Inside borders. Then, if desired, the sashing is sewn onto the blocks, and then the outside border is added to complete the table runner (see the back page for sashing instructions, which is not shown in the graphics below).

Pressing: Press all the seams facing in towards the outside border.

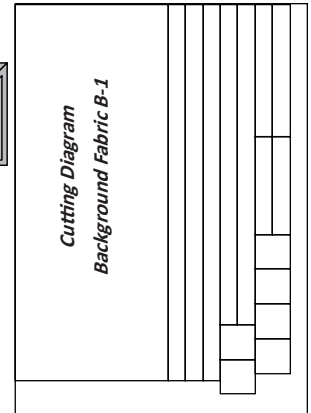

Binding and Quilting: Digitized designs for quilting may be available for this pattern on the Quiltworx Website. Once quilted, sew the binding strips together, end to end, at a 45 degree angle to extend around the perimeter of the table runner. Iron them in half along the length with the seam to the inside, then sew the raw edge to the raw edge of the table runner after it is quilted. Fold over and stitch to the backside.

Winter Wonderland

JNQ-90P
NP 134 6 Pages

Size: 17" by 49"

Table Runner

YARDAGE INFORMATION



FABRIC #	YDS	SKU	PLACEMENT
COVER SAMPLE BIRD OF PARADISE COLLECTION			
#B1*	3 2/3	TONGA B3273 FROLIC	BACKGROUND
#A2	1 5/8	TONGA B3274 CRIMSON	SNOWFLAKE SPIKES
#A3	1/4	TONGA B3270 SURF	CENTER STAR 1
#A4	1/4	TONGA B2583 VELVET	CENTER STAR 2
COVER SAMPLE SEASONAL PORTRAITS COLLECTION			
#B1*	3 2/3	JN-C3714 WHITE	BACKGROUND
#A2	1 5/8	JN-C3712 RED	SNOWFLAKE SPIKES
#A3	1/4	JN-C3712 GREY	CENTER STAR 1
#A4	1/4	JN-C3707 FROST	CENTER STAR 2
BATTING	22" X 54"	HOBBS 80/20	
*BINDING AND BACKING CAN BE CUT FROM LEFTOVER FABRIC FROM #B1 (as shown on Page 7). However, the quilts on the cover used different fabrics for the binding. You will need an additional 1/3 Yard of fabric in the color of your choosing to complete the binding if you want to complete it with a different fabric than the background, like shown on the cover.			

Look for the Coordinating Seasonal Portraits Thread Box By:

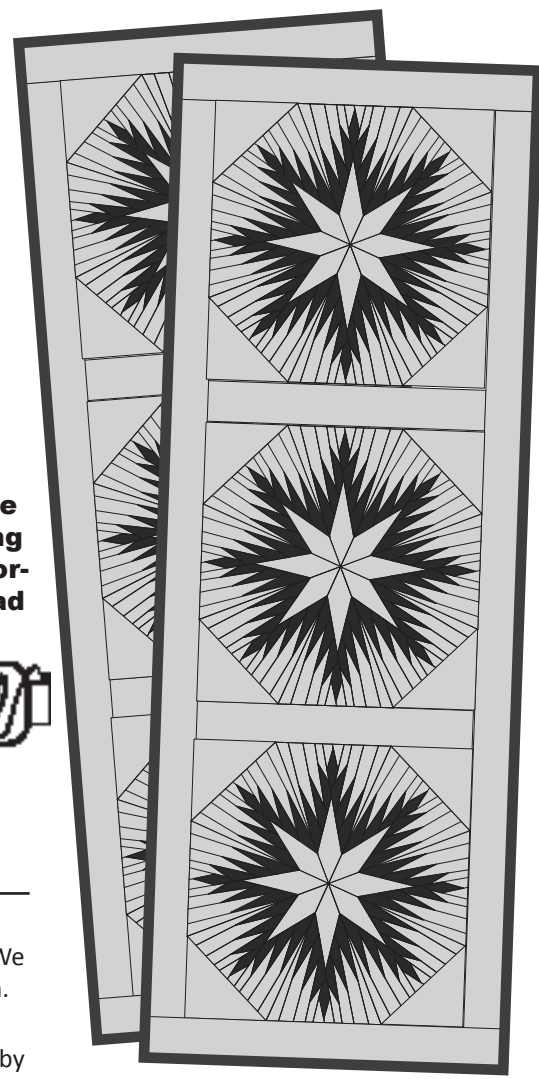

SASHING (OPTIONAL) YARDAGE INCLUDED IN #A2, ABOVE:

- Step 1:** Measure the width and length of the table runner.
- Step 2:** Cut enough 1-1/2" wide strips to fit around the perimeter of the table runner. We recommend cutting cross-grain strips, joined with a diagonal seam. Press the seams open.
- Step 3:** Press the strips in half, lengthwise, with *wrong-sides-together*.
- Step 4:** Sew the strip to the center of the runner (before adding the outside border) by opening up the pressed strip, aligning one raw edge with the raw edge of the top, then sewing down the crease. When you've sewn the strip to the table runner, then iron it back closed and add the outside border, accordingly.



© Copyright June 2010
Pattern: Winter Wonderland
All rights reserved. No part of this pattern can be reproduced in any form for any commercial purpose without the expressed written permission of Judy Niemeyer Quilting. The written instructions, foundation papers, graphics, and photographs for this pattern were designed as a package for the purpose of retail sales and as a result, fall under the protection of the federal copyright laws of the United States of America. Extra materials may be obtained from local quilt shops or directly from Judy Niemeyer Quilting aka Quiltworx.com.



E-mail: info@quiltworx.com • Web: www.quiltworx.com



Winter Wonderland

Print Date: 04-21-16