

► Cutting the Rectangles: Rectangle C:

Step 1: Cut (1) 4" by 10-3/4" stack of strips off the top of each set of rectangles. Clip (1) *GS-2 Template Layout Sheet* (Bag #2) on each Stack.

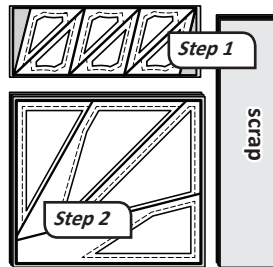

Step 2: Cut a 10-1/4" by 11-3/4" rectangle from the remaining fabric in each stack of Rectangle C pieces. Clip (1) each *BU2 Background Template Layout Sheet* (Bag #5) onto each stack as shown in the graphic.



Step 3: Take the pieces from Step 1 with *GS-2 Template Layout Sheets* attached and cut apart starting on Line 1. Place scraps in scrap pile and place template pieces in Bag #2, clipped together.

Step 4: Take the stacks from Step 2, and cut apart with the *BU2 Background Template Layout Sheet*. Clip the pieces together and place in Bag #5.

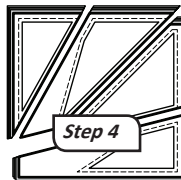

CUTTING DARK FABRICS #C1- #C18

Step 1: Stack (9) Strips together *right-side-up*. Make (2) piles.



Step 2: Subcut the following from the each of the (2) sets of strips.

- (2) stacks of (9) 9-1/2" x 16-1/2" rectangles (total of (4)) to go with the *BS Spike Template Layout Sheets (TLS)*.
- (2) stacks of (9) 6-1/2" x 10" rectangles (total of (4)) to go with the *CS Background Template Layout Sheets (TLS)*.
- (2) stacks of (9) 13-1/4" x 10-1/4" rectangles (total of (4)) to go with the *Border Unit 1 Spike Template Layout Sheet (TLS)*.

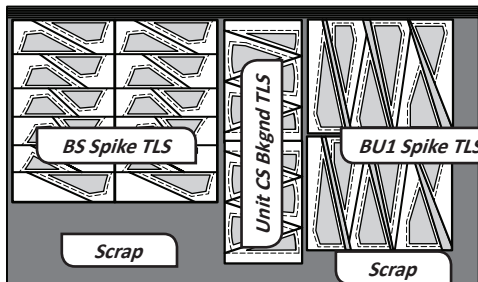

Step 3: Place (1) *BS Spike TLS* (Bag #1) on each 9-1/2" by 16-1/2" stack and cut around the outside. **Save the Scrap for Step 11.**

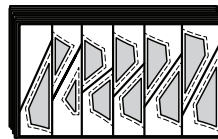

Step 4: Cut the template and fabric pieces apart. Place your ruler next to **Cut Line 1** on your *TLS*. Slice through the paper and fabric at the same time with your rotary cutter. Continue cutting on each line in numerical order until all the sections are cut apart.

Step 5: Keep the colors in order and clip the templates and

fabric pieces together for each section with binder clips. Place in Bag #1. Complete the cutting for all (4) stacks.



Step 6: Place (1) *CS Background TLS* (Bag #3) on the (4) 6-1/2 by 10" stacks of rectangles.



Step 7: Cut the template and fabric pieces apart, beginning with Cut Line 1 and continuing numerically, until all the lines are cut. Clip together and place in Bag #3.

Step 8: Sort out your favorite (24) rectangles and discard the rest. Restack into (4) groups of (6). Place (1) *Border Unit 1 Spike TLS* (Bag #4) on each of the (4) 13-1/4" x 10-1/4" rectangle stacks.



Step 9: Trim the excess fabric from around the template layout sheets on all (4) stacks.

Step 10: Cut on the Cut Line, clip together and place in Bag #4.

Step 11: Pick (4) colors from the leftover scraps to be cut with *Spike BU2-4 TLS* and *Spike BU2-2 TLS*. Cut (2) pieces the same size as each template, then stack the (2) pieces beneath each template and cut on the cut lines. Clip together and place in Bag #5.

NOTE - Keep the Colors in Order!: Be sure to keep the colors together in order.

NOTE - Sub-Bags Keep You Even More Organized: You might find it helpful keeping your piles separated from each other by placing in separate sub-bags before placing back into the respective Bag #.

CUTTING LIGHT FABRICS #B1 - #B6

Step 1: Cut (1) strip 16" by 42" of each Colors #B1 - #B6. Stack, then subcut each stack into (4) stacks of 16" by 10-1/2" rectangles.



Step 2: Place (1) *Border Unit 1 Background Template Layout Sheet* on each of the (4) stacks.

Step 3: Cut apart, starting on Cut Line 1.

Throw away the scrap pieces. Clip the pieces together and place in Bag #4.



NOTE - Keep the Colors in Order!: Be sure to keep the colors together in order.

NOTE - Sub-Bags Keep You Even More Organized: You might find it helpful keeping your piles separated from each other by placing in separate sub-bags before placing back into the respective Bag #.

CUTTING DARK FABRICS #G1 - #G6

The instructions in the pattern are written to use (6) geese fabrics, or three colors in each Geese Unit. The cover quilt only used (4) geese fabrics, or two colors in each Geese Unit. Both options can be done with 3/8 Yd of fabric (you only need (4) colors if you use (4)), but we chose to go to 6 colors so if you make a mistake, or the shop doesn't give you a perfect cut, there will be enough extra. The quilt can also be completed with only (1) color, in which case you need 1 5/8 Yd of fabric. It can also be completed using 1/8th yard cuts of (36) different colors.