

Fabric Width: The yardage amounts and cutting instructions were calculated to use 42" wide fabrics. If your fabrics are not 42" wide you may need to recalculate the yardage.

Fabric Strips: Quiltworx Bali Pops™ pre-cut 2-1/2" strip sets cut and designed by Hoffman Fabrics are available through many quilt shops. Cutting your own 2-1/2" fabric strips is also an option. If you choose to cut your own strips, the fabrics should be straightened and pressed before cutting.

Template Layout Sheets: The layout sheets are directional. To avoid making cutting errors, pay attention to the cutting instructions, making sure your fabrics are stacked appropriately before cutting.

The fabric pieces that are cut for the *Template Layout Sheets* are cut 1/4" to 1/2" larger than the actual size of the *Template Layout Sheets*. This makes it easier to center the layout sheets onto your fabric stacks, allowing you extra room for movement when cutting the fabrics into individual pieces.

Graphics: Our graphics are provide as a visual aid to help you position the *Templates and Template Layout Sheets* onto your fabrics prior to cutting.

CHAPTER ONE

Strip Piecing the Arcs: The 2-1/2" strips are sewn onto the foundation papers to make the arcs for Unit-A and Unit-B. You will need (48) strips to complete this quilt.

The Gemstone Wedding Star is made with (6) **Ring Color Sets**. A Ring Color Set is a group of (8) fabric strips blending in texture and value changing from one color family to another. The colors are shaded from light to dark. Color 1 is the lightest fabric in each group, leaving Color 8 as the darkest.

If you are using the Quiltworx Bali Pops, you will find that your **Ring Color Sets** have already been grouped together. When you open your package the first (8) strips are removed and clipped together with a medium size paperclip. Then, the second group of (8) strips are removed and clipped together. Then the third, forth, and etc.

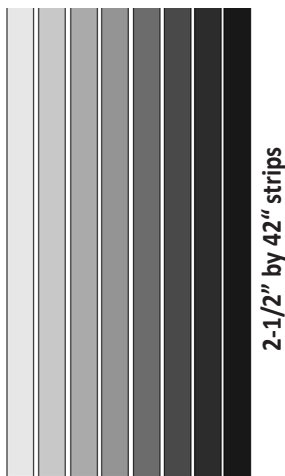
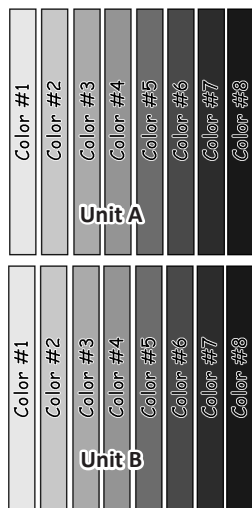

Preparing the Strips: After the strips in each color group are selected, the strips are cut in half leaving the length of each strip about 21" long. The first half-set is placed with Unit-A. The second half-set is placed with Unit-B. The strip sets are numbered 1-8. Color 1 is the lightest fabric in your group, color 8 is the darkest.

► Stacking the Strips Unit A: Bag #1

Step 1: After the strips are numbered, the strips are *rearranged* and stacked in the order they are sewn onto the foundation paper as shown.

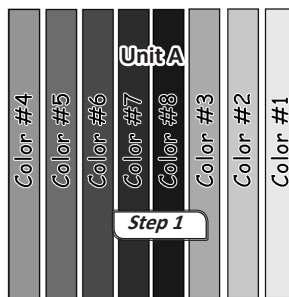

- Color 4, **Wrong-side-up**
- Color 5, **Right-side-up**
- Color 6, **Right-side-up**
- Color 7, **Right-side-up**
- Color 8, **Right-side-up**
- Color 3, **Right-side-up**
- Color 2, **Right-side-up**
- Color 1, **Right-side-up**

Color 4, and Color 5 are facing **right-sides-together**, with Color 4 on the top.

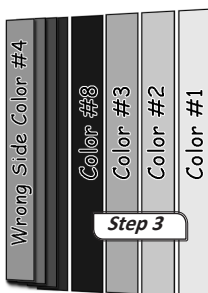

Step 2: Color 6 is placed **right-side-up**, under Color 5.

Step 3: Color 7 is placed **right-side-up**, under Color 6.

Step 4: Color 8 is placed **right-side-up**, under Color 7.

Step 5: Color 3 is placed **right-side-up**, under Color 8.

Step 6: Color 2 is placed **right-side-up**, under Color 3.

Step 7: Color 1 is placed **right-side-up**, under Color 2.

Step 8: The fabrics are clipped together and placed with seven (7) Unit A foundation papers. Place these pieces into Bag #1.

Repeat the stacking process for each **Ring Color Set**. You will have five sets with (7) papers and one set with (5) papers when you are done.

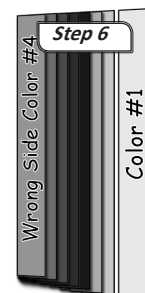
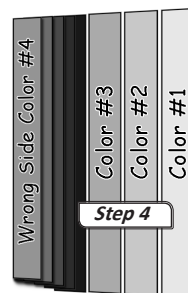
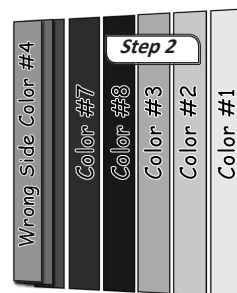

► Stacking the Strips Unit B: Bag #2

The second set of strips are numbered 1-8 as well. Color 1 is the lightest fabric and Color 8 is the darkest.

Step 1: After the strips are numbered, the strips are rearranged and again stacked in the order they are sewn onto the foundation papers. However, this time the stacking order for the color orientation is reversed.

