

FOUNDATION PAPERS, TEMPLATES, AND TEMPLATE LAYOUT SHEETS

Foundation Papers: The foundation papers are cut out by trimming the excess paper away, approximately 1/8" beyond the outside cutting line. Trimming off the excess paper will make it easier to position and sew the fabric pieces under the paper.

NP 202: Cut out (36) LC Units, (36) A Units, (36) B Units.

NP 203: Cut out (3) HLC-A Units, (3) B Units.

NP 204: Cut out (3) HLC-B Units, (3) B Units.

NOTE - There are no Extra Foundation Papers: The exact number of papers have been provided with these instructions. There are no extras!

Marking Your Dashed Lines: When sewing the fabrics to the foundation paper, each fabric piece must cover the underside area plus the extended seam allowance for each section you are sewing. The dashed lines on the units can be used to locate this area before adding your fabrics. It is helpful to mark these on at least the first few units as you are cutting them out and before putting them into bags. This can be done three different ways and each technique works.

1. I fold and crease the papers on the dashed line before I add the next piece of fabric. After creasing the dashed lines, I flip the paper over to find each section on the backside of the paper.
2. You can also trace the dashed lines on the backside of the foundation paper. This can be done by using a light-table or by placing the paper up to a window. Tracing works best when you are working on large foundation units.
3. Some people hold the paper up to a light-source to see if the fabric has been properly placed under the section they are sewing. This option would be done at the time of paper piecing.

Template Layout Sheets: A Template Layout Sheet is a grouping of several paper piecing templates into one template that is designed to speed up the cutting process associated with the individual fabric pieces necessary for each section on any given foundation unit in your pattern. Using Template Layout Sheets results in cut pieces of fabric that utilize the grain line of the fabric, minimize fabric waste, and keep your project organized. The Template Layout Sheets are positioned onto a stack of fabric. Then, your rotary cutter is used to slice through the paper and fabric, allowing several layers of fabric to be cut at one time.

You will find the Template Layout Sheets printed on the newsprint sheets labeled with a TP 101. Cut each Template Layout Sheet on the solid line around the edge of each layout. **Do not cut on the interior lines** until directed to do so in the next section of the pattern.

Template Layout Sheets

- Units LC, HLC-A, HLC-B Dark Fabric, 13-1/2" by 13"
- Unit A Background Light Fabric, 3" by 12"
- Temp G Dark Fabric, 2-1/2" by 18"
- Units LC, HLC-A, HLC-B Light Fabric, 14-1/2" by 13-1/2"
- Unit B Background Dark Fabric, 3" by 12"
- Temp G Dark Fabric, 2-1/2" by 18"

Organizing Your Papers by Bag: After you've cut out the foundation papers and Template Layout Sheets, organize them by Bag, according to the graphics to the right. You will need (5) gallon-size storage bags to keep your pieces organized.

BAG #1: UNIT LC, HLC-A, HLC-B

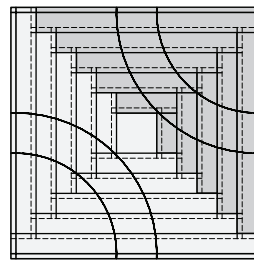

(36) Unit LC

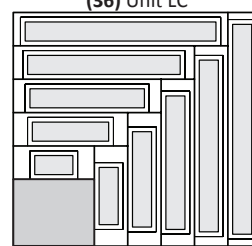

(6) Unit LC HLC-A, HLC-B
Template Layout Sheet
Dark Fabric

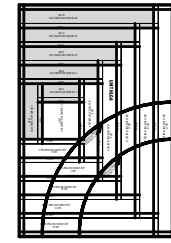

(3) Unit-HLC-A

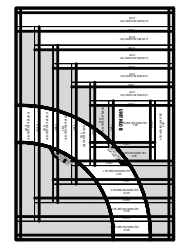

(3) Unit-HLC-B

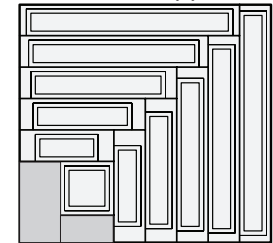

(6) Unit LC HLC-A, HLC-B
Template Layout Sheet
Light Fabric

BAG #2: UNIT A: COLORWAY #1

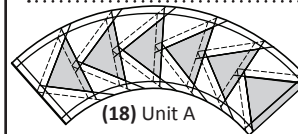

(18) Unit A



(3) Temp G Layout Sheets



(3) Unit A, Template
A1 Layout Sheets



(3) Unit A Template
A2 Layout Sheets

BAG #3: UNIT A: COLORWAY #2

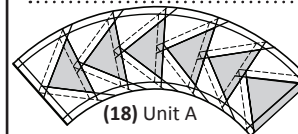

(18) Unit A



(3) Temp G Layout Sheets

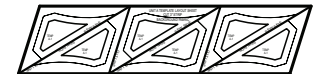

(3) Unit A, Template
A1 Layout Sheets



(3) Unit A Template
A2 Layout Sheets

BAG #4: UNIT B: COLORWAY #1

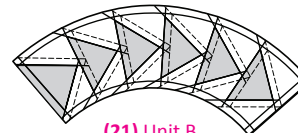

(21) Unit B



(3) Temp G Layout Sheets



(3) Unit B Template
B1 Layout Sheets



(3) Unit B Template
B2 Layout Sheets

BAG #5: UNIT B: COLORWAY #1

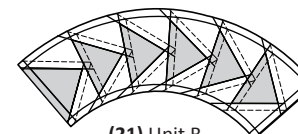

(21) Unit B



(3) Temp G Layout Sheets



(3) Unit B Template
B1 Layout Sheets



(3) Unit B Template
B2 Layout sheet

FOUNDATION PIECING UNIT A (36 UNITS) BAGS #2 AND #3

NOTE - Keep your Fabrics Organized: Work with Bag #2 first, then repeat these instructions for Bag #3 since the colors used are different.

Step 1: Place Unit A right-side-up on your table and position as shown.

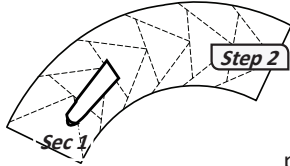

NOTE - Tracing the Dashed Lines: Turn the foundation paper over and trace the dashed lines on the backside of each unit.

Step 2: Find Sec. 1 on the foundation paper. Place a small amount of fabric glue on the back-side of the paper under Sec. 1.

Step 3: Position the fabric piece for Sec. 1 wrong-side-up on your table. Lift the foundation paper and position Sec. 1 over the top of the fabric as shown. Make sure the underneath side of Sec. 1 is covered with the fabric. The fabric must extend beyond the dotted lines located next to Sec. 1.

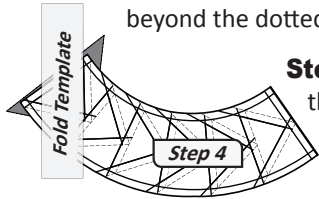

Step 4: Place the fold template over the top of Sec. 1, lining up the edge of the fold template on Line 1.

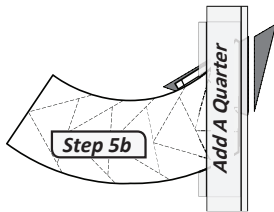

Step 5: (Graphic a) Fold the paper back on Line 1. (Graphic b): Trim the fabric with the Add-A-Quarter ruler.

Step 6: Place the fabric piece for Sec. 2, right-side-up next to the folded back paper as shown.

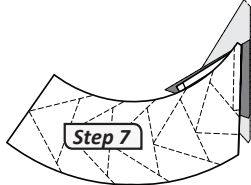

Step 7: Lift the foundation paper and position it directly over the fabric for Sec. 2. Line up the edges of both fabrics.

Step 8: Take both pieces to your machine with the paper. Open the paper and sew on Line 1. Always extend the sewing lines into the seam allowances.

Step 9: Flip the paper over and press the fabric pieces to the open position on the backside of the fabric. Don't press any folds into the seam lines.

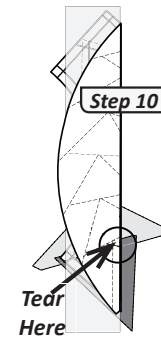
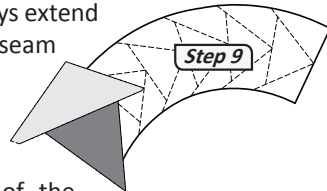

Step 10: Place the fold template over the top of Sec. 1 and 2. Line the edge up with Line 2. Lift the paper and tear the fabric loose from the paper at the top on Line 2.

NOTE - This allows the fabric to lay flat, making it easier to fold back the paper.

Fold the paper back over the top of the fold template.

Step 11: Place the Add-A-Quarter ruler next to the folded edge of the paper, lip-side down, and trim the fabric with your rotary cutter.

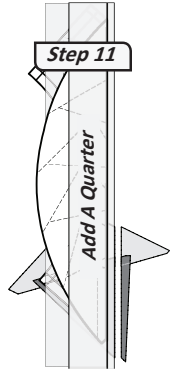

Step 12: Place the next piece of fabric for Sec. 3, right-side-up next to the folded back paper as shown.

Step 13: Lift the foundation paper and position Sec. 3 directly over the fabric. Line up the edges

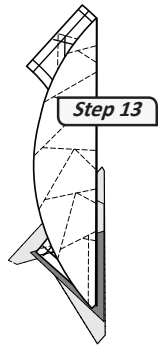
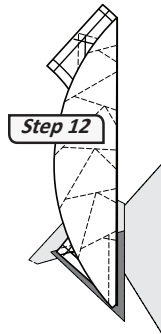

of both fabrics.

Step 14: Take to your sewing machine and sew on Line 2. Press open.

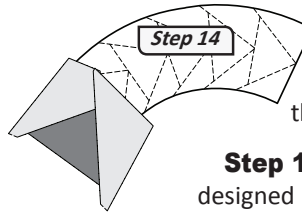

Step 15: Continue adding each piece to the foundation paper until the paper piecing is complete.

Step 16: Our foundation papers are designed with two solid lines around the perimeter of each unit. The trim line on the foundation paper is the last solid line around the outer edge. After you have complete the trimming, place the finished units into Bag #2.

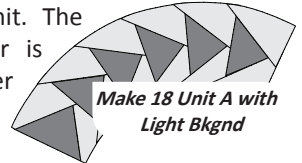

Step 17: Repeat with Bag #3 to make (18) units with the dark backgrounds.



FOUNDATION PIECING UNIT B (42 UNITS)

Unit B is made the same way as Unit A. The only difference is the direction the osprey are flying. The stacking and piecing process is the same as before. We have added a couple graphics below to get you started with the stacking and the first piece of fabric. After you complete the B Units place the pieces back in the appropriate Bag #4 or #5.

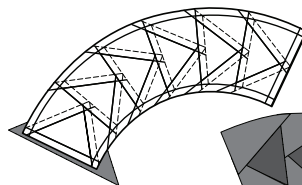

Make 21 Unit B with Dark Bkgnd: Bag #5

