

Labeling Your Foundation Papers by Colors: If you have (6) fabrics in each stack, number your papers 1 to 6. Paper #1 is used with the 1st fabric in each stack, paper #2 is used with the 2nd fabric in each stack, and etc. Keeping the papers in sequential order as you sew each round keeps the fabrics organized finishing with one accent fabric and one background fabric for each arc.

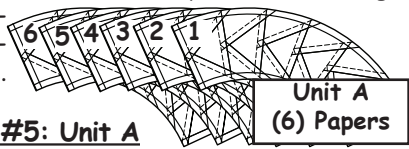

Foundation Piecing: Bag #5: Unit A

Step 1: Start with Group 1 of 4 in Bag #5, Place Unit A right-side-up on your table and position as shown.

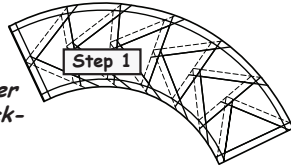

Note: Turn the foundation paper over and trace the dashed lines on the back-side of each unit.

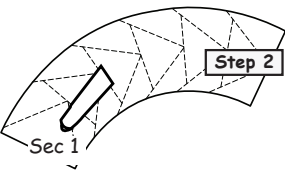

Step 2: Find Sec. 1 on the foundation paper. Place a small amount of fabric glue on the back-side of the paper under Sec. 1.

Step 3: Position the fabric piece for Sec. 1 wrong-side-up on your table. Lift the foundation paper and position Sec. 1 over the top of the fabric as shown. Make sure the underneath side of Sec. 1 is covered with the fabric. The fabric must extend beyond the dotted lines located next to Sec. 1.

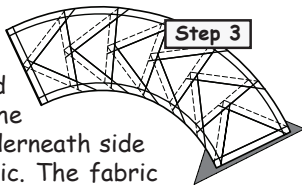

Step 4: Place the fold template over the top of Sec. 1, lining up the edge of the fold template on Line 1.

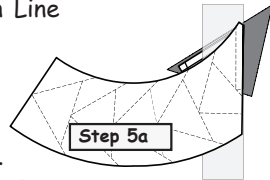
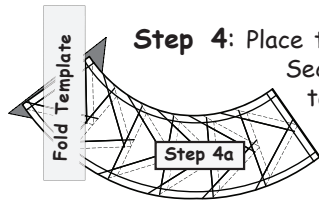

Step 5a: Fold the paper back on Line 1.

5b: Trim the fabric with the *Add-A-Quarter* ruler.

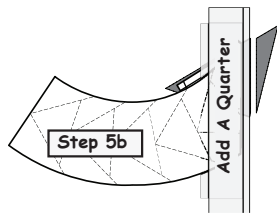

Step 6: Place the fabric piece for Sec. 2, right-side-up next to the folded back paper as shown.

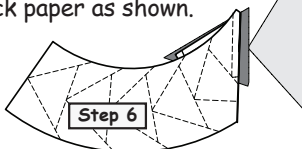

Step 7: Lift the foundation paper and position it directly over the fabric for Sec. 2. Line up the edges of both fabrics.

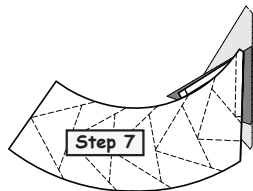

Step 8: Take both pieces to your machine with the paper. Open the paper and sew on Line 1. Always extend the sewing lines into the seam allowances.

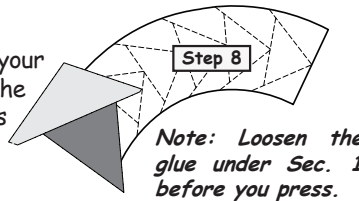

Note: Loosen the glue under Sec. 1 before you press.

Step 9: Flip the paper over and press the fabric pieces to the open position on the backside of the fabric. Don't press any folds into the seam lines.

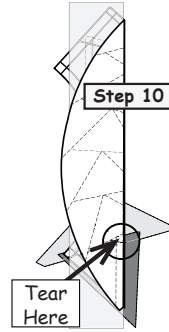

Step 10: Place the fold template over the top of Sec. 1 and 2. Line the edge up with Line 2. Lift the paper and tear the fabric loose from the paper at the top on Line 2.

This allows the fabric to lay flat, making it easier to fold back the paper.

Fold the paper back over the top of the fold template.

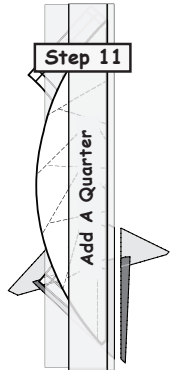

Step 11: Place the *Add-A-Quarter* ruler next to the folded edge of the paper, lip-side down, and trim the fabric with your rotary cutter.

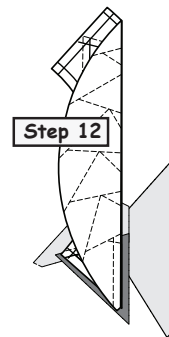

Step 12: Place the next piece of fabric for Sec. 3, right-side-up next to the folded back paper as shown.

Step 13: Lift the foundation paper and position Sec. 3 directly over the fabric. Line up the edges of both fabrics.

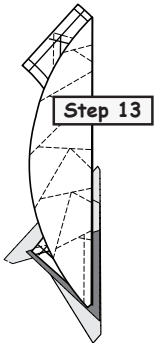

Step 14: Continue adding each piece to the foundation paper until the paper piecing is complete.

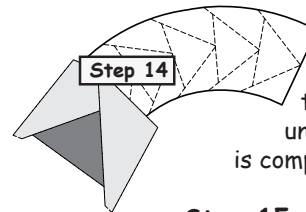

Step 15: Our foundation papers are designed with two solid lines around the perimeter of each unit. The trim line on the foundation paper is the last solid line around the outer edge. After you have complete the trimming, place the finished units (*Group 1 of 4*) into Bag #1 with the Log Cabin blocks.

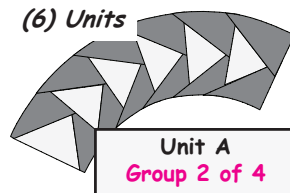
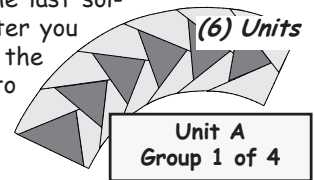

Return back to page 7 and start again with the A Units in Bag #5, (*Group 2 of 4*). These A Units are sewn with the dark accent fabric and light triangles. When you are finished, place the units into Bag #1 with the Log Cabin blocks.

Foundation Piecing: Bag #5, Unit B:

Unit B is made the same way as Unit A. The only difference is the direction the osprey are flying. The stacking and piecing process is the same as before. We have added a couple graphics at the top of the following page to get you started with the stacking and the first piece of fabric. After you complete the B Units place the pieces in '*Group 3 of 4*' and '*Group 4 of 4*' into Bag #1 with the Log Cabin blocks. {Bag #5 can be discarded}

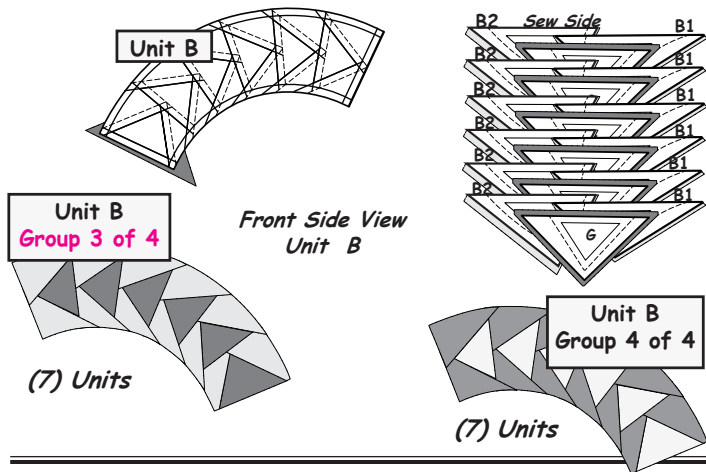

Foundation Piecing: Bag #6 & 7, Units A & B:

Follow the previous piecing instructions for Units A and B. When the units are finished, place the pieces into the appropriate bags.

Bag #6, Unit A, & B: Place the finished pieces into Bag # 2 with the Log Cabin Blocks.

- Unit A: Color Group 1 of 4, (6) pieces, Bag #2*
- Unit A: Color Group 2 of 4, (6) pieces, Bag #2*
- Unit B: Color Group 3 of 4, (7) pieces, Bag #2*
- Unit B: Color Group 4 of 4, (7) pieces, Bag #2*

Bag #7 Unit A, & B: Place the finished pieces into Bag # 3 with the Log Cabin Blocks.

- Unit A: Color Group 1 of 4, (6) pieces, Bag #3*
- Unit A: Color Group 2 of 4, (6) pieces, Bag #3*
- Unit B: Color Group 3 of 4, (7) pieces, Bag #3*
- Unit B: Color Group 4 of 4, (7) pieces, Bag #3*

Cutting Out the Log Cabin Cutouts:

With the completion of all of the foundation paper piecing, it is now time to begin assembling your quilt. Prior to sewing the units together there are sections of the Log Cabin Units that must be cut out. These are referred to as the 'Log Cabin Cutouts'.

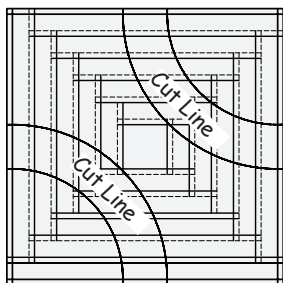

Step 1: Flip your LC Unit over to the printed side of the paper so you can see the lines.

Step 2: Cut on the curved dashed lines that are labeled 'CUT LINE AFTER FOUNDATION PIECING IS COMPLETE.'

Note: You don't need to throw away the cut out arcs. We have designed a couple quilts which, are Companion quilts to our Log Cabin designs that use the cutout concept. Click on the code on the back page located in the lower left corner. Note that you may need extra yardage to use these cutouts with this pattern so you will want to download the alternative yardage information.

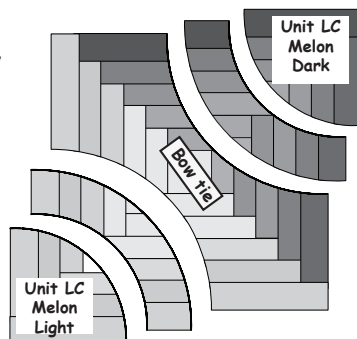

Step 3: The Log Cabin Cutouts, are replaced with the A & B Units.

Step 4: Divide the blocks in each bag into two groups. The Log Cabin Cutouts, are replaced with the A & B Units. Each block is sewn with (1) each of the A & B Units. It is recommended that you name your blocks, (Block 1 and Block 2) before placing them on your design wall.

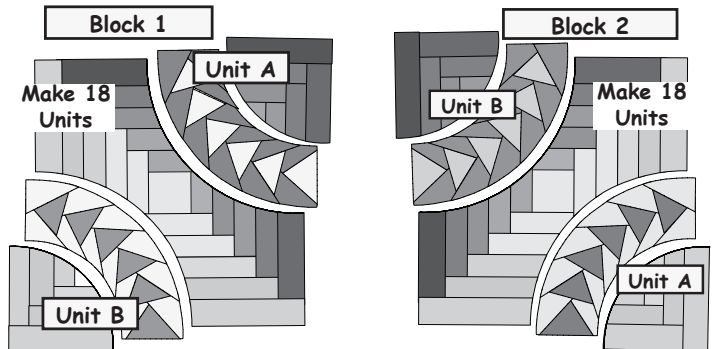

Pay attention to the flying direction for Units A and B. The quilt blocks were designed so the Osprey migrate up. An even number of A and B blocks are made in each group.

You should also have (1) each of 'Unit HLC-A and HLC-B. These blocks are completed with the B Units. The light B Unit is sewn into Unit HLC-A. The dark B Unit is sewn into Unit HLC-B. *Refer to the Graphics at the bottom of page 10.

It is recommended that you arrange your blocks prior to starting your curved piecing. *Please refer to the exploded view layouts on pages 10 and 11 for your arrangement.

Note: There are many ways to arrange these units. Playing with the blocks and color placement of each unit is lots of fun! You may be surprised at the different shapes that come into play as you move your colors around. Once you are happy with your arrangement you can begin the curved piecing.

Curved Piecing: Unit LC / Melon:

Note: Set your machine to sew a quarter-inch seam allowance before you begin the curved piecing.

Step 1: The A and B Units are sewn onto the light and dark melon pieces. The *light background/dark Osprey* are paired up with the *light melon* pieces. The *dark background/light Osprey* are paired up with the *dark melon* pieces.

Step 2: If you have not already done so it is time to remove the foundation papers on the A & B Units.

The foundation papers can be removed under sections 1, 2, 3, 6, 7, 8, 10, 11, 13, 14, 16, & 17 on the A Units. The paper should remain in place under all the A-2 template section.

The foundation paper is left on the melon unit to help stabilize the melon during the curved piecing process.

Step 3: Position the arc onto the light melon as shown with right-sides-facing together.

