

Mitered Border Technique

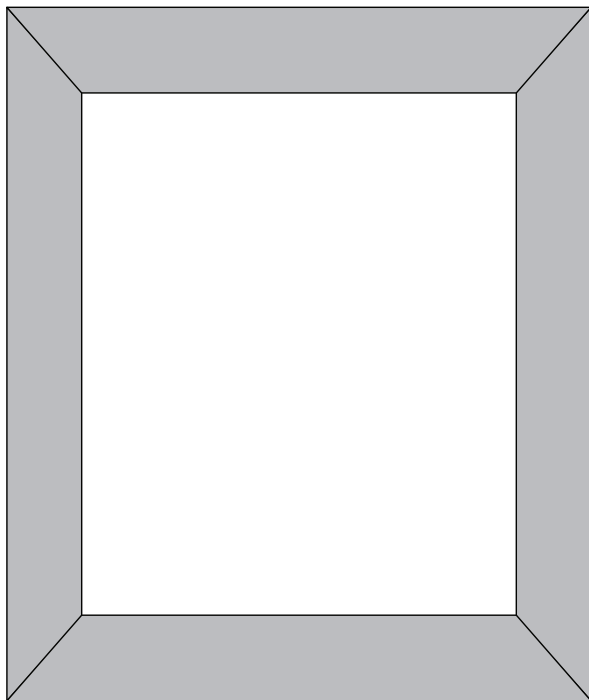
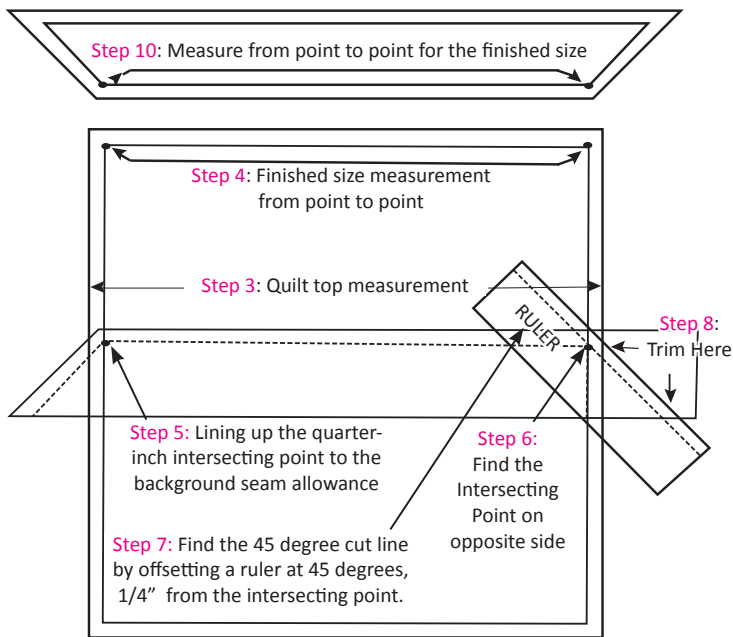

QUILTING DESIGNS

Quiltworx.com has completed a variety of digitized quilting designs for several of our patterns. Carrie Barone quilted the cover sample of the Farmer's Star with some great western themed designs, including Barbed Wire Stars, border, wagon wheels, horseshoes, wood grain borders, and wheat bouquets. Carrie has indicated that she intends to list these designs on the Quiltworx website in the coming months so that they can be downloaded by others seeking out western themed quilting designs that fit the blocks included in the Farmer's Star quilt.

To find these designs, visit Quiltworx.com, go to Products: Digitized Quilting Designs, and find the listing for Carrie Barone. There may

be other designs available on the website that fit this quilt, as well. So, please visit and see if these products are available yet, for download!

Quiltworx.com recommends Hobbs 80/20 batting or similar to get a nice, thin, but flexible finish to the quilt.

DOUBLE EDGED BINDING

Double Folded Straight Edge Binding: From the fabric you selected for the outside binding, cut enough strips at 2-3/4" wide to go around the perimeter of the Quilt. Strips may have already been cut from Color #17 (Black) along the Selvage of the fabric cut. The strips are joined together at a 45 degree angle, then pressed in half before sewing them onto the quilt. The joining seams on the strips should be pressed open to prevent the extra bulk when folding the binding over the edge of the quilt. The binding is sewn onto the top-side of the quilt with your machine and hand stitched on the backside.

Choosing a Different Binding Color: If you do not want to use the Color #17 for your binding, you will need to purchase additional yardage and can cut a series of 2-3/4" x 42" strips, accordingly. An additional 5/8 of a yard of fabric will be required to complete the binding for the quilt if you choose a different color. Sew these together as noted above.

ALTERNATIVE COLORWAYS AND COLOR PLANNING

Many people purchase our patterns and then choose to make them out of fabrics that are not shown on the coversheet. Information is included on Page 4 of the pattern to determine yardage, by section of the quilt. In addition, you can "audition" colors for the quilt in a variety of ways.

First, there is a picture of the quilt on Page 15 of this pattern. You can use this picture and colored pencils to develop your own unique colorway for the pattern.

Another option is to visit the website, where a line drawing of the pattern is available under the Official Samples tab for download. An electronic version can either be printed out and colored, or it can be uploaded into photo editing software and swatches of fabric or color can be used to color the quilt in your preferred colors.

If you want inspiration from other quilters, Quiltworx.com includes an album on the pattern page of quilts completed by customers if they have been submitted to us. These photos are uploaded on Facebook, then automatically fill the Facebook Gallery on the pattern page. We also pin these to Pinterest so you can find them there, as well.

YOUTUBE VIDEOS AND TUTORIALS

Quiltworx.com has also recently started a Youtube Channel. Search for us on Youtube to find general tutorials on paper piecing! We have recently completed construction of a Video Station in Judy's new Sewing Studio. And, we plan to continue to add to this video library with helpful tips, tricks, and information to make paper-piecing a breeze for those that choose to use this technique to make their quilts! Subscribe to our channel to receive notifications when we post something new!